

DX MONITOR

PUBLISHED BY

THE INTERNATIONAL RADIO CLUB OF AMERICA

VOLUME 12 NUMBER 6 OCTOBER 26, 1974

HANDICAPPED AID PROGRAM

GENE MOSER, DIRECTOR

6805 WOODLAND COURT

COLOMA, MICHIGAN 49038 U.S.A.

The Handicapped Aid Program has formed a Planning Committee to work on details for a universal committee to promote, construct and distribute information about and for HAP projects. The HAP International Coordinating Committee (HICC) has been set up.

HAP was begun in 1972 by SPEEDX, but it is now completely independent, except for a column in SPEEDX. It is now an inter-club organization. HAP has over 50 members. At present there are two chapters, one in England and one in Canada. The following services are given free to members: club memberships (some at half cost), Pen Pals, equipment, handbooks, Blind DXers Course by Arthur Cushen, translations, plus instructions on an informal basis and in a monthly newsletter, Spearhead.

HAP is presently beginning its year-end fund drive, to raise funds for free memberships, etc. Donors should send their contributions to HAP Headquarters, 6805 Woodland Ct., Coloma, MI 49038. Please include your club affiliation. HAP will notify each club of donors and the total contributed. This is a worthy cause, so please help.

HAP has recently revised its policies to include BCB, Utility, FM, and TV DXers as well as SW DXers.

HAP feels that each HAPie should contribute to the bulletins of all clubs they belong to, to show their interest in the club and the hobby.

(Ed. Note-- at present IRCA does not have any set policy regarding HAP. We haven't been asked yet officially to contribute a membership/subscription to a HAPie. Perhaps this might be something that we as an organization could do to promote further fellowship among DXers. Let's hear your comments in DX Forum. FJP)



ARCHIVES

Some months back, the question was posed whether anyone knew of any museum which would be willing to accept collections of veries and other memorabilia from deceased DXers, to preserve a little bit of 20th century American culture. Skip Dabelstein notes that some years ago the topic was discussed at an NRC Convention. It was suggested that such collections be displayed at the club convention each year and then stored with the convention hosts until the following year, when it could be shipped on to the new hosts at club expense. Good idea or not? What do you think? Express your ideas in your DX Forum.

Editor: John Zondlo

central dx forum 608 N. Martin

Muncie, IN 47303

Allen W. Ogrizovich-3836 Sleepy Hollow Lane-
Fort Wayne, IN 46804

Hi one and all! Well to be truthful the old rx has hardly been on. Only really new DX is for the follow up stuff. Been noticing that the non-verifiers are verifying. Or many stations want a follow up. Speaking of veries: after about the 3rd report I finally got a verie from WMBA-1460. Remember they had a test for us about this time last year. Well, Richard A. Pantaleo, CE, sent me a letter verifying my report and made a mention in the things for all who never got them send a report to him. Also had a mention of a station clean out where anything not filed that day got thrown out including the PoP test. What a mess. Other than that here are the other veries: v/l WCMU, WYCH, WDHK; v/q WHIO, WWSW, WKYX, WELO. As mentioned before all other veries in the veries signers list. Was great to see the IRCA gang at the NRC. Yes, the white coon is still OK Mr. Fifth. Oops 4th. As for the shiek, DX is down and GX is very active. Just having fun in the sun. Since this is my last line I'm gonna say baaaaaaaaa.

John Zondlo-608 N. Martin-Muncie, IN 47303

Greetings. A good bit of DXing done around this way, but few stations IDed. Such is life. I've got a new job down here...tape jockey, newsman, etc. at WWHC 104.9 Hartford City, IN. Only working Tuesday and Thursday night. Well, hope DX is better for the rest of you. Don't forget---deadlines are every Thursday!!! See you in 7.....

WKBR

AM & FM

155 Front Street
MANCHESTER,
NEW HAMPSHIRE

5000 Watts 1250 kc

Verification of reception of WKBR on

June 18, 1972 at 12:40 - 1:10 PM EDT

Thanks for the report.

69

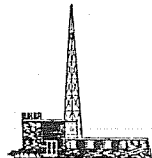

W. J. ...
Chief Engineer

DX MONITOR, the official magazine of the International Radio Club of America, is published weekly from October to March, bi-monthly in April, May, and September, and monthly in June, July, and August. SECOND-CLASS POSTAGE IS PENDING IN SAN DIEGO, CA. Official business address: 3266 Nutmeg St., San Diego, CA 92104. POSTMASTER: SEND FORM 3579 TO IRCA, 12536 ARABIAN WAY, POWAY, CA 92064.

SUBSCRIPTIONS: For IRCA members: \$7.50 (plus \$2.00 membership fee); airmail, \$11.00 (+ \$2.00); airmail to Central and South America, \$18.00 (+ \$2.00); airmail to Europe and Africa, \$23.00 (+ \$2.00); airmail to Oceania and Asia, \$28.00 (+ \$2.00). Non-IRCA members, add \$3.00 to IRCA rates. Sample copies, 50c or 2 International Reply Coupons. Make all checks or money orders payable to IRCA. Canadian subscribers, please use Canadian Postal Money Orders payable in U.S. funds. Other foreign subscribers, use International Money Orders payable in U.S. funds. Send all funds for membership, subscriptions, as well as changes of address, to Poway address above. Please enclose self-addressed stamped envelope in correspondence with publishing headquarters if reply is expected.

PUBLISHING STAFF: Executive Editor: Father Jack Pejza (714-282-2184); Publisher: Grant Manning, 714-566-1264; Dave Stroup, Albert Lobel, Randy Seaver, and whoever else shows up, such as Dan Sheedy and Fred McClelland.

Kapt 1220

SALEM, OREGON

*** NEW MEMBERS

Artie Bigley, 436 Nassau, Apt. 118, San Antonio, TX 78213.
(rejoin)
Stanford J. Shaw, 12227 Tweed Lane, Los Angeles, CA 90049
Myron Gray, 1739 East 26th St., Brooklyn, NY 11229 (rejoin)
Keith M. Mehl, 3120 S.W. 12th St., Des Moines, IA 50315 (rejoin)
Hal Christianson, 555 Community Row, Winnipeg, Manitoba
Canada R3R 1H6
William Boonstra, 18724 148th Ave., Spring Lake, MI 49456

"THE TWIN CITIES COUNTRY MUSIC TWINS"

KTCR AM 690 kc
Radio
FM 97.1 mc

MINNEAPOLIS - ST. PAUL

eastern dx forum

Editor: Bruce R. Heimburger
1710 Cambridge Rd.,
Ann Arbor, MI 48104

Brh - Ann Arbor, MI

It's now Thursday & I haven't gotten a rpt all week. I have one from last week which you all will see shortly. Come on now, cx can't be that bad. So let's have a little larger EDXF next time.

C.M. "Stan" Stanbury II - Box 218 Crystal Beach, Ontario LOS 1B0, Canada

Herbert W. Armstrong, best known (along w/his son Garner Ted Armstrong) for THE WORLD TOMORROW radio program, claims in the Oct-Nov. issue of his PLAIN TRUTH magazine "King Hussein is now planning to install a two-million watt radio station at Amman, and I ascertained that time will be available to us on this possibly unprecedented superpowered station. Incidentally, my meeting with King Hussein was televised on Amman TV." Interestingly, Armstrong was one of only two evangelists whose programs were carried by R. Swan/Americas as part of their obviously phony cover as a commercial stn, i.e. it was probably intended that the press "discover" R. Swan's "CIA status" thus effectively hiding the military nature of the operation (recently detailed in the Oct. PE). In short, THE WORLD TOMORROW has some extremely interesting high level international connections. Best.

John Simmons - POB 127 - Amityville, NY 11701

I guess my rpt on WARD really got to you guys, & for a good reason. I made a mistake. My rpt should have read "WARV, Warwick - East Greenwich, RI" not "WARD, Johnstown, PA." The calls are the same except for the last letter. The new 1974 BYE just arrived. It's packed full of info but it has a few mistakes and out-of-date facts on some stns. In spite of all that, it's an excellent publication, second to DXM, hi. Radio reception is a bit better, but it's still punky. To all of you silent members: start sending in your reports today!!! We all want a huge EDXF and only "we" can do it!

Dick Clark - 4460 NE 31 Ave.
Lighthouse Pt., FL 33064

Hi everyone. This will be my last rpt in IRCA after being a member of this club for 5 years, in which has been most interesting. Why? My subscription is ending is the reason, but I am not giving up DXing, if that is what you think!!! I am very strong on BCB-SW-TV DXing and in the future will be giving my DX info to Ron Schatz by phone. Maybe later I will rejoin IRCA. Right now I will be in Sto Domingo w/Cesar Objio for another weekend on LW as well as BCB & FM DX. I bought a new Collins R-390 from Ed Platt of SC in which it is really the best RX I ever had!!

I got it for a very low price. Now I am going to sell my SX 62A on which I could never tell what freq. I was on in the first place. If you ever think about getting a Collins rx, the only thing I would say is buy it. Well good DX. 73s

Dave Schmidt - 42 Chelwynne Rd.
Castle Hills - New Castle, DE 19720

Figured that now was a good time as ever to get in a few lines. Not much has been going on here in the line of veries, only one back is a v/1 from WPTS from last June. A few rpts and a lot of follow-ups have gone out this week, and even a CPC request. Hope the cx improve somewhat this year as the last few days in Sept. were really zeros for SSS DX. Looks like the new KCAA-1560 will make a formerly hard state easy in the east following WQXR & WDXR s/off. If you have any v/s make sure you get them to me as they would be mighty handy! What gets me is that I'm running ones that I need here!

western dx forum

Editor: Michael G. Worst,
4618 Fremont N., #104
Seattle, WA 98103

Wm. Larry Cowles, 362 W. Marcus Dr., Tucson, AZ 85706

Not a whole lot to say. I didn't DX the entire summer and can't seem to find much time now that the season has started. Only new logging has been KCAA-1560, now on RS. A few veries managed to come in since last report: v/1 KCRL KEX KROP KSMA KAJN KJSK KREO KTW KCYN KYOS KUBA KJIM. v/f KXYZ KGMO WAOK. v/r KLOV KUVR KCAD KPGE WCSC. v/q WSPD WLCY. Some of these may have been reported before. 73's.

Albert S. Lobel, 247 N. First St., Apt 27, El Cajon, CA 92021 TELEPHONE (714) 440-2544

Hi! It's been awhile since I sent in a Forum report so I thought it about time. Hope the DX season is treating all well; it is me! Received letter from KREO in which the General Manager thanked me for sending him a tape recording of my reception and thought the idea to be unique. Just shows that some stations like to receive tapes from DX'ers. The response, so far, to my new column has been good; I'd like to see more ads appear, however. Let's see if I can get enough to fill an entire page of DXM, not just a small corner. For those of you not yet familiar with my new column it is called the "AD-VISOR," look for it in back issues of DXM. Well, that's it for this report. 73's to all. San Diego Padres World Series Champs in '76!

International Radio Club of America
12536 Arabian Way, Poway, CA 92064



SECOND CLASS POSTAGE
PENDING AT SAN DIEGO,
CALIFORNIA

70

SECOND CLASS

dx monitor supplement



VOLUME 12 NUMBER 5B OCTOBER 26, 1974

DX CALENDAR DX CALENDAR DX CALENDAR

All times Eastern Local Time

Mon. Nov. 4	0300-0330	WLOR	730	Thomasville, GA	5 kw	D1
	0330-0400	KHUB	1340	Fremont, NE	.5/.25 kw	U1
Mon. Nov. 11	0205-	WTAW	1150	Bryan, TX	1 kw	D1
	0230-0300	KDLT	540	Delta, UT	1 kw	D
	0300-0330	WTKM	1540	Hartford, WI	.5 kw	D1
	0300-0330	WCSJ	1550	Morris, IL	.25 kw	D1
Fri. Nov. 15	0000-0100	WERA	1590	Plainfield, NJ	.5 kw	D3
Mon. Nov. 18	0300-0330	KRMO	990	Monett, MO	.25 kw	D1
	0400-0440	KTLK	1280	Denver, CO	5/1 kw	U1
	0500-	KQXI	1550	Arvata, CO	10 kw	D1
Mon. Nov. 25	0200-0300	KFUO	850	St. Louis, MO	5 kw	L1
	0300-0330	KPUB	1480	Pueblo, CO	1 kw	D3
Mon. Dec. 2	0200-0230	KNEL	1490	Brady, TX	1/.25 kw	U1
	0300-0330	WHBN	1420	Harrodsburg, KY	1/.5 kw	D1
Tues. Dec. 3	0645-	KRME	1460	Hondo, TX	.5 kw	D1
Fri. Dec. 6	0000-	WJKL	1310	Asbury Park, NJ	1/.25 kw	U5
Mon. Dec. 16	0300-	WSLT	1520	Ocean City, NJ	1 kw	D3
Mon. Dec. 23	0400-0500	KCNO	570	Alturas, CA	5 kw	D1
	0500-0600	KAFY	550	Bakersfield, CA	1 kw	U2
Mon. Jan. 6	0100-	WMLO	1570	Beverly, MA	.5 kw	D3
	0200-0400	WIMS	1420	Michigan City, IN	5 kw	U4
	0200-0550	WACE	730	Chicopee, MA	5 kw	D1
	0300-	WAAB	1440	Worcester, MA	5 kw	U4
Mon. Jan. 20	0130-0200	WPAR	1470	Farrell, PA	1 kw	U2
Mon. Feb. 10	0100-0200	WGIL	1400	Galesburg, IL	1 kw	U1

WLOR - no program details. Reports of "The Georgia Giant" go to Rich Harris, Box 45, Thomasville, GA 31792. Arranged by Skip Dabelstein for NRC.

KHUB -- will probably have code ID's, TT, and march music. Send reports to Vern Wirka, Production Director, KHUB, Box 669, Fremont, NE 68025. Arranged by Skip Dabelstein for NRC.

WTAW -- erroneously reported earlier as 11/9. No program details. Send reports to Antone J. Nemec, WTAW, Box 3008, Bryan, TX 77801. (Actually listed in NRC Log for College Station, TX.) Arranged by Larry Ledlow, Jr. for NNRC.

KDLT-- no program details. Verie signer will be Glen S. Gardner, GM, KDLT, Box 327, Delta, UT 84624. Arranged by Skip Dabelstein for NRC.

WTKM -- no program details. Write Richard Feutz, CE, WTKM, 27 N. Main St., Hartford, WI 53027. Arranged by Skip Dabelstein for NRC.

WCSJ -- no program details. Write Bob Cooper, CE, WCSJ, Box 270, Morris, IL 60450. Arranged for NRC by Skip Dabelstein.

Several tests have been scheduled on short notice, and as a result, we haven't had the opportunity to let the members know in advance. Such a test was WOND-1400, Pleasantville, NJ, which tested Oct. 28 from 0000-0045 with TT and IDs. If you heard them, reports go to Ed Storck, CE, WOND, P.O. Box 352, Pleasantville, NJ 08232. Arranged by Jim Hopkins for IRCA.

Along those lines, please allow sufficient time when arranging tests so that IRCA/NRC/NNRC can be informed. And please notify all three clubs.

To make sure that CPC information gets into the first possible bulletin, send CPC info (and flash tips) directly to Father Jack Pejza, 3266 Nutmeg St., San Diego, CA 92104. Sending it to Poway possibly could mean a delay of a week in getting into the bulletin.

Skip Dabelstein tells us he didn't arrange the CJKD test. Ron Sibbit, the CE of the station, is a member of NRC and set up the test.

BROADCASTING

INFORMATION

(as compiled by Mike Worst)

WQBx	710	5-D	Blacksburg, Va.	start operation
new	1060	1-D	Tallapoosa, Ga.	requests WTLG
WHYT	1110	4-D	Noblesville, Ind.	change DA pattern
new	1510	5-D	Milbank, S.D.	granted KMSD

Geomagnetic Indices

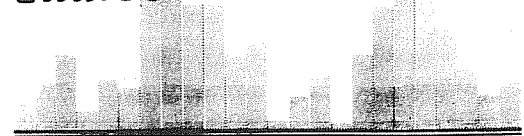

Oct. 9-15 28 9 7 19 51 22 39

Conditions were relatively good through 12 October and then became severely disturbed for a large portion of 13 October, following a sudden commencement geomagnetic disturbance which began 1244 UT 12 October. Conditions improved 14 October but were moderately disturbed again 15 October. Conditions should be unsettled 17-24 October.

DX FORUMS

Editorial Policy has been that each member is allowed 15 full lines (which appear as about 20 shortened lines in our two-column format) each issue in DX Forum. Some dissatisfaction has been expressed with this policy. Just as an experiment, let's try lifting that 15 line limit for a couple of issues, to see if it helps or hurts. Remember, your Forum should be restricted to DX-connected topics. No long lists of stations heard--they belong in DX Roundup. Try to make your Forum interesting, but remember that others don't want to be inundated with your remarks. (Personally, I rarely found enough to say of interest to most members which would take the full 15 lines. FJP).

IMPORTANT NOTICE

Effective immediately, Father Jack's phone number is 714-282-2184 only.

eastern dx roundup

CAROL SCHWEIGER
55 TALBOT AVENUE
STRATTON HALL, BOX 58
TUFTS UNIVERSITY
MEDFORD, MA 02155

Well, it's good to be back after such a long absence. I'll be setting everything up the same as Mike, so continue reporting as you have. DEADLINES: every Monday, 12 days before date of publication.

*****	950	*????*	??	unID;10/7; TT t/in 0135 thru apparent s/off 0155 w/nary an audible ID, if any. Looped E-W and definitely interesting in that direction, weak signal. Who?(TRS)
	1340	*WJRI*	NC	Lenoir; 9/30, w/ET-TT, IDs every minute noted 0030-0045. Some good IDs for tape file, new.(TRS)
		WMBO	NY	Auburn; 9/28, s/off 0102 mentioning WRLX-106.9 mc, w/SSB.(TRS)
		WTRN	PA	Tyrone; 9/28, w/c&w mx, taking dedications on local & Altoona lines, ID picked out 0015, 0047. Fair sig at peaks. New.(TRS)
	1560	*WBKC*	OH	Chardon; 9/26, w/ET-TT-OC-mx commencing 0110 w/day facilities IDs 0158, 0210, 0220 t/out. Looking for the new SD, not hrd (TRS)
		WGLB	WI	Port Washington; 10/7, w/ET-TT (1 kHz)-OC w/c&w t/in 0210, IDs 0215, 0230 t/out, fair signal (TRS)

1580 KWNT IA Davenport; 9/26, s/off 2015 w/o SSB, fair sig for tape file w/o sign of CBJ. New, first time able to copy SSS this far west. (TRS)

WAMY MS Amory; 9/26, s/off 2000 w/referal to WAFM-95.3 mc, followed by the end of the WCCR s/off, w/o SSB. Again 9/27. Bad het/hum on freq, Foxworth says by listening to tape WAMY is off freq which WCCR beats against until WAMY carrier goes off. (TRS)

+++++
 BROUGHT TO YOU BY:
 (TRS)-Tom R. Sundstrom/Box 205/Willingboro, NJ 08046
 +++++
 Only one reporter this week; thanks Tom!! For an intro: I'm 18 and a freshman at Tufts U. in Medford, Massachusetts, majoring in math. I've been out of touch with DX for a while, but I hope to get back into it soon. Until next time, 73's, and the best of DX. Carol.

central dx roundup

Editor: John C. Keleher,
 Box 7543, Fairfield Stn.
 Fort Wayne, IN 46807

THE HAT TIPPED THIS WEEK TO:

- JA - JIM ALBRECHT, 3313 N. Weil St., Milwaukee, WI 53212 (Sony CRF-5090)
- GRB - GEORGE BERTONZ, 9515 So. Kilbourn Ave., Oak Lawn, IL 60453 (HQ-180A, SM-2)
- JEB - JOHN BRADLEY, 2617 Holiday Lane, Colorado Springs, CO 80909 (Realistic Astronaut-8)
- KDF - KARL FORTH, 630 South Ardmore, Villa Park, IL 60181 (HQ-160, SM-1)
- GH - GLENN HAUSER, 1312 W. Oak, Enid, OK 73701 (HQ-160, NW/SE and NE/SW LWs, SM-2)
- JTP - JIM POGUE, 11 University - Apt. 2, W. Lafayette, IN 47906 (Zenith Royal 7000-Y, SM-2)
- DRW - DON WEINZIERL, 6100 W. 97th St., Oak Lawn, IL 60453 (Hallicrafters SX-42, SM-1)
- JCK - Editor (XCR-30, etc.)

- +++++
- 550 KOY AZ Phoenix, 9/30 0145, fair-good, talk show o/another talk show, heavy QRM from K TSA and KSD? (JEB) (KSD possible - Ed.)
 - K TSA TX San Antonio, 9/30 0540-55, Nx, Wx and R&R Mx, poor to fair o/u WKRC (GRB)
 - 590 KLBJ TX Austin, 9/30 0159, good, s/off saying only "KLBJ, Austin" (JEB) (ex-KTBC? - Ed.)
 - 620 CKCK SAS Regina, dominating channel 0224 10/7, w/local ad for Gondola's luncheon special (GH)
 - 630 KHOW CO Denver, pseudo s/off plugging Doubleday 0204 10/7, then went on with RS (GH)
 - 680 KNBR CA San Francisco, 9/28 0730, very good and alone w/Wx for the Bay Area, best reception here yet(JA)
 - 720 KQRX? NV Las Vegas? 10/2 2349, very strong OC o/Cuban and WGN when nulled, 4 Hz SAH. From this? (GH)
 - 810 KAFE NM Santa Fe, 9/28 2039-59, fair, C&W Mx w/spots, "Cafe Calendar," ID for AM and FM (JEB)
 - 850 WYDE AL Birmingham, briefly fair in KOA null 2255 10/13, C&W Mx, ID, jingle and Ai Nx (JCK)
 - 90C KFAL MO Fulton, 9/28 0715-24, fair-good w/WOKY QRM, had Nx, Wx and many local spots, C&W Mx (JA)
 - 930**KSDN**SD**Aberdeen, 10/7 0305, good on ET (DRW) 10/8 0735, ID followed by farm program, fair o/u WBCK, WTAD (GRB)

- 950 KLIK MO Jefferson City, 9/22 2028, noted w/SID and AT40 program (KDF)
- 980 KFWB CA Los Angeles, 9/16 0321-40, poor, all Nx stn, w/PSAs and IDs, o/u UnID f/c (JEB)
- 1050 CJIC ONT Sault Ste. Marie, good 10/7 2002-2010 w/ad for C&W Mx Month Contest (JTP)
- WCEF WV Parkersburg, 9/30 0714, poor to fair, 3 commercials and fade-out
- 1150**WGOW**TN** Chattanooga, testing (GRB) again w/usual R&R, 9/30 (KDF)
- 1170 KVOO OK Tulsa, extended its SP MM 10/7, allowing LA reception past 0200. Intermittent OC; was back on RS by my 0300 check (GH)
- 1280 WWTC MN Minneapolis, fair 10/7 2016-27, w/EL Mx and frequent IDs (JTP)
- 1300 KGLO IA Mason City, in for a quickie ID and local ads, 2031-35 10/7
- 1310 WDOD TN Chattanooga, fair (JTP) w/TN Wx report, ID, and C&W Mx.
- 1340 WMID NJ Atlantic City, 9/23 0503, poor w/WJOL looped w/ID, rock Mx(KDF)
- 1350 CKLB ONT Oshawa, 10/6 0152, good w/Mx and spot for Zeller's (DRW)
- KCOR TX San Antonio, SS (fulltime) novela interrupted by ID 9/30 2045, proclaiming its 5 mil watts dia y noche (GH)
- 1360 KLRS MO Mountain Grove, 10/6, good w/s/off starting 1934 (GRB)
- 1380 KTSM TX El Paso, Wx, ID and "Meet the Press" 0133 10/7 (GH)
- 1390 KJPW MO Waynesville, 9/26 0701, poor w/s/on, then SSB (KDF)
- WCSC SC Charleston, fair w/"Hit Parade" pop Mx 0338-59 10/14, many IDs, no sign of usual WFBL, WNUS (JCK)
- 1400**KBRB**NE**Ainsworth, may have been their r/c hrd 0122-32 10/12, fair tones, 1 min. on, 30 sec. off, no ID hrd tho (JCK)
- 1410**KAHL**NE**North Platte, OC and ET annemt, then 1 kHz tone, 0132 10/7 (GH)
- KRIG TX Odessa, 10/2 0021, o/WING with several spots (KDF)
- 1420 KTOE MN Mankato, s/off acknowledging its ties w/USWB, 0130 10/7 (GH)
- KLUF TX Lufkin, s/off just after KTOE w/jazzed-up Zarathustra, 0131 10/7 (GH)
- 1440 KEWI KS Topeka, 9/28 0116-20, fair, R&R Mx w/Bruce Wayne, "KeeWee Constant Comment." Stn awards cakes to birthday folks,hi (JEB)
- 1450^h?UnID??LA Definitely Louisiana in ID, state Nx 0700 10/1, on 2nd harmonic 2900 (GH)
- 1460 WCMB PA Harrisburg, 9/23 0459, fair w/s/on w/WBNS (KDF)
- 1470^h KTDL LA Farmerville, ID in passing 0729 10/1 on 2940 kHz, mixing with TGRY (GH)
- 1480 KWIZ CA Santa Ana, 9/30 0210-0300, good o/KLMS before KLMS s/off, "Quiz talk" w/Pat Michaels, PSA, AM-FM s/off. Called stn and CE was really surprised. I rate this as my best catch so far. It might not be far, but those mts. sure do block signals (JEB) (Exlnt catch and report--Ed.)
- KLEO KS Wichita, 9/27 2035-46, poor-fair till pattern change o/u WISM/WHBC/KBEA, ID at 2045, oldies R&R (JA)
- 1500 KWFA TX Merkel, tropical Mx, SS annemts, not // 15110 so not XERH, 2040 9/30. SS ID at 2043, then EE s/off (GH)
- 1520 WHOW IL Clinton, 9/24 1950-2000, fair-good w/C&W Mx, exlnt on s/off using instr. version of "Here Comes the Sun" (JA)
- 1530**WKDC**IL**Elmhurst, 9/21 0140, noted ETing w/OC, first nite test as far as I know (KDF)
- KCLR TX Ralls, closing SS program 3 hours long, 2100 9/30, EE s/off (GH)

western dx roundup

Editor: Jeff Brasler, 10341 Shirley Ave., Northridge, CA 91324

Tests and changes etc.....

- 1540 WPTR NY Albany, on RS 0251-0321 10/14, R&R and many promos, QRM from TTR assumed KXEL. If WPTR is NSP now, good-bye Nassau (JCK)
WSWG MS Greenwood, dominating w/local ads and ID, 2011 10/3 (GH)
KGBC TX Galveston, 9/19 2050, on top w/soul Mx, record hop ads (KDF)
1560 KAJN LA Crowley, 9/19 2027, fair with s/off, first time on RS (KDF)
WBKCOH**Chardon, hrd ETing with tones and small talk from engineers. Gave them a call and really shocked them. They became very "official" on the air after the call.
WTODOH**Toledo, 10/12 0120-31, testing w/pops by gal singer, one very garbled ID 0125 (JCK)
KKASD**Aberdeen, 9/30, ET w/OC, IDs at 0517 and 0532, o/u TT of WQXR (GRB) Exlnt 9/21 0124, w/C&W Mx, ID as KK double A, regular after WDXR s/off, anncd as 24h, off around 0115 MMs (KDF)
1570 WFRL IL Freeport, 9/28 0750, good over WFRL w/ID during local Nx (JA)
WKKS KY Vanceburg, 9/22 1955-2000, poor -fair w/much fading, local spot ment. "Diving Center of KY," very weak s/off 2000 (JA) Poor 9/24 0601 w/s/on (KDF)
KLEX MO Lexington, 9/29 2032, good w/s/off o/KTER (KDF)
WTRB TN Ripley, 9/28 1955-2000, poor-fair w/C&W Mx, to s/off w/SSB(JA)
KVLG TX LaGrange, 9/19 2028, fair over static, w/s/off (KDF)
KTER TX Terrell, 10/6 1955-2001, s/off w/SSB, religious talk, fair to good (GRB)
WYTI VA Rocky Mount, 9/28 1924-25, with football scores and ID (JA)
1580 WEYY AL Talladega, 10/6 1916, fair w/s/off (KDF)
WBBA IL Pittsfield, 10/8 1930, poor on s/off (DRW)
1590 WAIK IL Galesburg, 9/20 2015, poor with "This is WAIK on 1590 khz," apparent s/off (JA)
WQTC WI Two Rivers, 9/24 2000, fair over WAIK/WNTS w/s/off (KDF)
1600 WKWF FL Key West, 10/2 w/CBS Nx, Wx, religious thought and s/off with SSB 0011, one to look for during aurora (KDF)
WKDL MS Clarksdale, 9/28 2015, fair w/s/off using jingle. Local line noise nearly wiped out ID (JA)
KATZ MO Saint Louis, 10/14 0225 w/rock-blues, NSP now? (JCK)

- 720 KQRX NV Las Vegas, per verie is concluding its 3 year CP. XR located in Henderson. 50kw Day-ND, 10kw Nite-DA w/lobe towards LA, whoopee!! V/S Joseph D. DeAngelo-CE, KQRX, 1536 Sombrero Drive, Las Vegas, NV 89109. (JAB)
800**KDDD**TX***Dumas on NRC Test (not listed in DXM) 10/14 0210-0230. Country music w/IDs after every song. Fair w/XEROK off. Slight QRM w/KABC slop. Was 1st caller. CE seemed very interested. (JAB-CA)
1010**KIQI**CA***San Francisco on ET w/c1 mx 10/12 0440-0456+. Xlnt w/KDJW. Slight QRM. (JAB-CA)

550 KOY AZ Phoenix 10/3 0540 w/TC, ID, very poor reception. (RB-CA)
KMVI HI Wailuku, in most every day w/good signals. MM 10/14 in as strong as KOGO w/rr music. In mornings until 1030. A rock show by a DJ there is from 0700-1000. ID at 1000, then Philipino program w/mandilines. No other Hawaiians noted in the morning after LSR. Usually in fighting w/KOY, KAFV. (DN-CA)
KBOW MT Butte 10/8 0730 w/Montana state news, wx, ID fair o/KOY. (RB-CA)
590 KUGN OR Eugene 10/4 0510 w/ID, TC, contest rules, poor reception. (RB-CA)
+10/14 0700 w/Steve Ward and the network nx, ID, poor. (RB-CA)
620 KTAR AZ Phoenix 10/4 0455 w/nx, wx, ID. Good reception. (RB-CA)
+10/8 0600 w/AZ news, ID, PSA for Fire Prevention, good. (RB-CA)
630 KIDO ID Boise 10/8 0630 w/wx, ID, old hits, fair.(RB)
730 CKLG BC Vancouver 10/8 0755 w/rr, ID, fair. (RB-CA)
770 KXA WA Seattle o/u JOUB w/el mx 0915-0920 10/1. Thought when KOB faded I'd have a clear channel for TP's here until this pest showed up. (ECR-CA)
810 WGY NY Schenectady here 10/6 0345-0530 w/el mx. "WGY w/mx til dawn" ID 0515. KCMO weaker than normal and no sign of CFNC (I sure hope you don't hear CFNC on 810 cause it's on 1060!:-JAB); KGO off of course. NY #6 for ms. (ECR-CA)
860 ??? ? unID heard here 0610-0615 9/23 in FF w/Caradian sports. Suspect CJEC Toronto.(ECR)
910 CJDV ALB Drumheller fair o/u KISN 0510-0600 9/23 w/"Light in the Night Program". Nx w/IDs on hc and half hour. (ECR-CA)
KISN WA Vancouver fair o/u CJDV w/rr, wx and IDs 0515-0530 9/23. (ECR-CA)
920 KGAL OR Lebanon s/off 10/14 after KVBC, KORK, KOLO s/off. Good w/no SSB. (JAB-CA)(9300)

PER THE LIST: (Tnx KDF!) (KDF)
Sept. 4th Fri: KSIW-1450-OK, 1k T, 3min IDs
4th Sat: WABD-1370-KY (KDF)
Oct. 1st Tue: WHGR-1290-MI (steady and "wavy" T) (KDF)
1st Sun: KCII-1380-IA (KDF)
1st Mon: KNOX-1310-ND (KDF)
KFSA-950-AR (KDF)
KGHL-790-MT not hrd (KDF)

I don't know how many times editors have to say it, but initials are being left off again, and in the future if they are left off in the report they will be left off in the column. A couple of entries herein should point out that I ain't kidding! Oh well, the guy left out the dates and times so maybe it's just as well.73-Charley

- opps..
750 KFQD AK Anchorage fair 0650 10/7 o/u looped WSB w/ID and Alaska wx. Not heard since last January. (ECR-CA)
1060 KUPD AZ Tempe 10/4 0715 w/rr, ID, TC, gud. (RB-CA)
KPAY CA Chico good on 10/5 at 0503 w/CA nx, at 0504 a spot. (KDS-CA)
1130 KWKH LA Shreveport fair w/CKWX nulled on 10/5 w/cw at 0517. Southern accent DJ gave time and "56 in Shreveport" at 0519. Into cw mx. (KDS)
Vancouver 10/7 0445 w/the John Michaels show, ID, sports, ad for Jolly Miller or drink. Poor. (RB-CA)
1180 ??? ? unID fair to poor 9/31 (tsk, tsk, only 30 days to Sept. you know-JAB) w/top 40 at 0232 and gave time (MDT), then into mx. No ID heard. KOFI?? (KDS-CA) (Probably-JAB)
1220 CJOC ALB Lethbridge 10/14 0555 w/wx, nx, ID. Fair reception o/XEB. (RB-CA)
CKDA BC Victoria 10/6 0640 w/TC, ID, older pops. Fair. (RB-CA)
1230 KCBN NV Reno 10/7 TC, ID, pops at 0630. Poor. (RB)
1240 KCLV NM Clovis 10/5 w/many nulled, end of Top 40 mx at 0531. Gave ID, TC (MDT) and ment request line was open at 0533. (KDS-CA)
1260 CFRN ALB Edmonton good 0730-0745 9/23 w/mx, IDs and nx. KYA noted off for about only the second time ever. This is a good night w/3 NSPers and about 10 ANers off. (ECR-CA)

WRBN 1600 AM 101.7 FM radio

P. O. Drawer AB Warner Robins, Ga. 31093



TIGERADIO 1400 DETROIT

- 1300 KROP CA Brawley hrd 9/31 w/KWKW nulled. C&W mx at 0155 Ad for Broadcast Tech school and more C&W at 0155. "It's 11 o'clock, time for KROP mx" at 0200. (KDS-CA)
- 1330 KPOK OR Portland 10/5 0645 w/ad for Humane Society, wx, ID, fair. (RB-CA)
- 1360 KICK NE McCook fair 9/30 0710-0715 w/call and spot for Nebraska Football game. 0/all sorts of unIDs. (ECR-CA)
- 1370 KGNO KS Dodge City fair w/IDs and nx 0720-0730 9/30. Parkville fair //CHUB-1570 9/15 0530- (ECR) 0600. ALL IDs were for both stns and the CHPQ ones mentioned "Parkville-Quallicum" as location. KEEN in SP. (ECR-CA)
- 1380 KTWOM CA Salinas hrd 10/5 w/cw 0111-0118, ID and spot at 0119 "K-TOM country 138". Seems to me they were top 40. (KDS-CA)
- 1400 KONG CA Visalia 10/5 w/nx at 0200, ID and Fresno temp at 0205. (KDS-CA)
- 1430 CKFN ONT Toronto poor u/many 0710-0715 10/7 w/ID, wx and sports. (ECR-CA)
- 1460 KENO NV Las Vegas 10/5 at 0130 w/ads for Vegas Hotel. Fighting it out w/KDON. (KDS-CA)
- 1480 KLEO KS Wichita fair o/unID 9/30 0645-0700 w/CDT TCs and KLEO Wichita ID on hour. (ECR-CA)
- 1540 WPTN NY Albany 0500-0516 10/14. RR mx w/ID's after every song. Good w/KBES QRM. (CCC-CA)
- 1560 WRIN IN Remnselaer; hrd vocal SSB 0700 10/7 and decided to stick around. After SSB a "WRIN Remnselaer Indiana" came through to clinch this much wanted station for state #34. Also 400th station heard. (ECR-CA)
- KKAA SD Aberdeen noted a couple of times in late Sept. in RS w/KEMC off putting good signals this way. Should be an easy SD for anyone needing it. (ECR-CA)

W-A-N-T-E-D

Heath GD-125 Q-Multiplier. Am willing to pay \$15 plus postage. Must be in working condition. CONTACT: C. R. Weinstein, Post Office Box 52, Golden City, MO USA 64748.

COMMENTS:

I will not divulge the name of the caller! I will only say that someone called me collect to try to put an ad in this column. PLEASE, NO COLLECT CALLS! I PAY MY PHONE BILLS AND SO SHOULD ALL OF YOU! Enough said!!

Response to this column is starting to pick up. I would still like to fill an entire page of DXM if I had the info. It would take a lot of typing considering that the printing in DXM is reduced by approximately 6% but, I'd be more than happy to do a full page. SEND YOUR ADS IN NOW! GET WHAT YOU WANT BEFORE X-MAS (HANAKKUH, FOR ME)!!

I would like to know what the results have been with the ads that have been placed in this column, so far. I would most certainly appreciate hearing from those who have placed ads. The information I would like to know is: How fast did you sell or buy the items advertised? did you get the price you wanted? and, what do you personally think of the column and its format? Any other information you could tell me would also be very helpful to me. I am open to receiving any and all suggestions! I may use the better ones!

LOOK FOR MY WDXF REPORT ELSEWHERE IN THIS EDITION (I HOPE MIKE GOT IT IN TIME!).!.

73's and good DX to all,
Albert

From Publishing Headquarters

The supplement sent out last was listed as Volume 12, Number 5. The supplement this week will be Number 5B. Each week from now on, until the second-class permit is settled, the supplement will be one number behind the official DXM. That way you'll get your full complement of 34 issues (i.e., 34 supplements).

Last week's issue was put together in somewhat of a rush, since the postoffice was closed on Monday, Oct. 14. Ordinarily DXM is assembled on Monday afternoon or evening and taken to the printer on Tuesday. Because of the rush on Tuesday, a couple of typographical errors appeared last issue; most embarrassing, especially since one glaring one was on the first page of the supplement.

This issues reporters are:

- (RB) Richard Bessette- 706 Polk Street- San Francisco, CA 94109 (DX-150-B)
- (CCC) Cliff Connelly- 10042 Comanche- Chatsworth, CA 91311 (DX-150A w/box loop)
- (DN) Dick Nelson- 3470 Travis Avenue- Simi Valley, CA 93063 (Motorola Transistor Radio)
- (ECR) Eric C. Rittenhouse- 77 Linaria Way- Menlo Park, CA 94025 (HQ-160 w/4' loop, SM-2)
- (KDS) Kirk D. Schneider- 781 Cedarwood Drive- La Habra, CA 90631 (DX-150B)
- (JAB) Jeff Brasier- your editor (HQ-129-X w/2' box loop)

No reports out but one verie in, that from KQRX (see 720). Please do not report clears, as they will be cut. A postcard received here from a new member named Joseph. Who are you?? Remember, deadlines are every Thursday. 73's.

The Ad-Visor

EDITOR: ALBERT S. LOBEL PHONE ADS ACCEPTED AT: 247 N. FIRST STREET, APT. 27 (714) 440-2544
ET. CAJON, CA USA 92021 1900 THRU 2130 PST/PDT

Anyone having items for sale or trade is invited to send the info. to me for publication in this column. Please be sure to state the nature of the items for sale or trade, the price and condition of the items. Also, be sure to include your complete mailing address (INCLUDING ZIP CODE). Your phone number may appear; be sure you include your area code. All items should be of a DX nature. Include a SASE if a reply is expected from your editor!

S-W-A-P

Have 336 hours of old radio programs on reel-to-reel tape at 3 3/4 IPS (4 track). Will swap programs, or will send a copy of any program you want if you pay for tape and postage. All were recorded off KVI-570 and have commercials edited out, except for few with original commercials. CONTACT: Michael G. Worst, 4618 Fremont N. #104, Seattle WA USA 98103. PHONE: 206 632-3608 (no collect calls, please).

F-O-R S-A-L-E

DXM's from approximately mid November 71 thru June 74. Send \$2.00 for postage costs to: Tom Butas, 5612 Alta Dena, Huntsville AL USA 35802. PHONE: 205 881-1378 (no collect calls, please).

G-I-V-E A-W-A-Y

SW4A instruction manual, DX150 owners manual. FREE to first one to write. NO RP NEEDED! CONTACT: William Trubee, Post Office Box 1323, Kealahakua, HI USA 96750.

THE LOUISVILLE TIMES, WEDNESDAY, OCTOBER 9, 1974

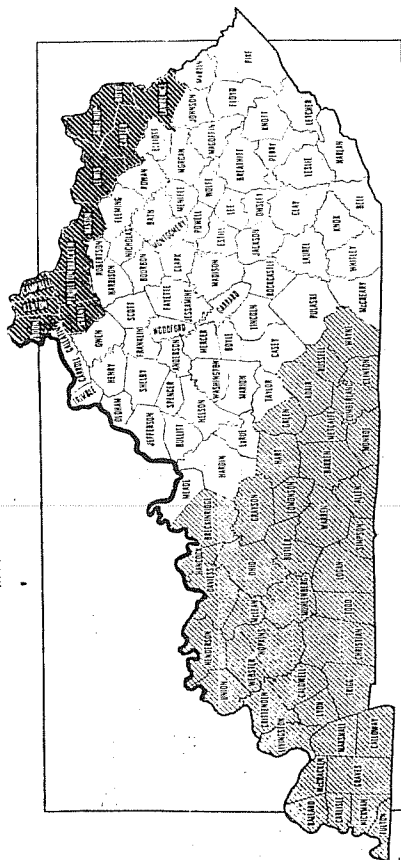

Staff Map by Johnny Austin
white will shift from Central Daylight to Eastern Standard time; western counties (thin black stripes) will shift from Central Daylight to Central Standard Time. Only the black and shaded counties clocks will actually change.

If Gov. Wendell H. Ford's request to the U.S. secretary of transportation to change Kentucky time zones is granted, the change will affect counties Oct. 27 as follows: Counties in black will go from Eastern to Central Standard Time; counties in white will shift to Eastern Standard Time.

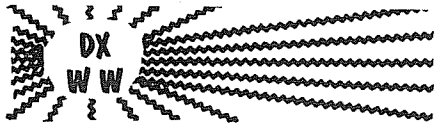

Ron Schatz \$ Box 592814 AMF \$ Miami, FL 33159
AC305-945-4915 \$ Deadline: Wednesdays

Remember a YL IRCA'n from St. Petersburg, FL - Virginia Lyle? I gravely mention that she just passed away, an indirect victim of drugs. I can attest from experience that the %age of DX'ers on drugs is surprisingly large; and to qualify the following opinion, I must mention that I have tried Colombian grass twice in curious experiment, so I know what I'm talking about: Anyone who chooses to debilitate his/her brain & nervous system in exchange for getting "high" on life & love is missing some marbles! (If this paragraph saves a life it won't be out of place - RFS)

Notas de RFS

ARGENTINA: The Argentine government now requires all stations in that country to play at least 75% Argentine music in the proportion of 1/3 urban (tangos), 1/3 rural (zambas), & 1/3 pop, second the Miami Herald.

BELIZE: Present announced facilities include 834 in Belize City, 910 in Punta Gorda, 930 in Corozal, & 3.3 mhz in Belmopan. 920-Belmopan has been discontinued.

COLOMBIA: The correct name of the new Cartagena-1170 is "La Voz de la Heroica", thus differing from WRTH's "Bocagrande" (cf. DXWW 9/7), & the RFS mis-ID "Pueblo" of last issue. Gives a street address with every ID, but not when I've got pen & paper handy, hi. \$ A new north-coaster 'is showing up on 1230 khz.

CUBA: Santiago's CMKU is now on 640 khz, ex 650. \$ CMQA-820 is now "Radio Metropolitana". Announced address: Avenida 26 N 877, Nuevo Vedado; Habana 6. (Could be 867, will recheck)

Precision Frequency Measurements

Measurements taken 10/4 between 2100-2400 UTC. Estimated reader's-time accuracy +/- 4 Hz.

Omega	625479	Artemisa	1158583
Rebelde	779952 \$	Paraíso	1162793
4VEH	1034949	"RC"	1211035
Canajagua	1046720	Reloj Nac.	1306520
Revolución	105918.	Monumental	1374558
Capital	1124589	San Carlos	1462527
Orientales	1155044	Pedernales	1561120

\$ - CMJN noted on 783 khz 10/11-13.

Vampires, ghouls, werewolves, DX'ers, & other creatures of the night:

- Jeff BRASIER; Northridge, CA (HQ-129X, box loop)
- Eric FADER; Bayside, NYC (Candle TK-1848, CTR-18C)
- Karl FORTH; Villa Park, IL (HQ-160, SM-1)
- Glenn HAUSER; Enid, OK (HQ-160, SM-2, etc.)
- Albert LOBEL; El Cajón, CA (DX-150A, Sanserino loop)
- Randy MINNEHAN; Columbus, OH (DX-150A, 78cm. DCL)
- Eric RITTENHOUSE; Menlo Park, CA (HQ-160, SM-2)
- Richard SHAFTAN; New York, NYC (Philips IC, SM-2)

Trans-Pacific DX Roundup

- 647^t RSFSR? A stn noted here 10/7 from about 1315 to LSR. Only time really readable was about 1340 when I think it was in KK. The time & lgg match a report in the 10/5 DXWW, so probably RSFSR. Carrier was pretty strong, but most audio was lost to KNBR/KFI slop (Rittenhouse)
- 650 HAWAII, Honolulu, presumably KORL noted w/phone -in show, 524- prefix. HJ must be nulled 0840 (Hauser) 10/14.
- 655^c KOREA-N, P'yongyang noted after 1200 9/30, 10/1-2, 10/5-8 usually very good in KK. Especially good 9/30 1150-1205 w/very dramatic-sounding YL. Usual fade precluded any sort of ID on hour (Rittenhouse) \$ 10/7 1120. In fairly good w/slop from KFI. Sort of classical march-type music w/YL in KK. Heard also at 1140 w/OM in KK, sounded like he was giving a nx b'cast. After nx, Oriental mx. This makes a new country for me (Lobel)

- 700 JAPAN, synchros very poor 10/5 1350-58 // JOBB w/mx. Probable NHK ID by YL 1357. Lost to KNBR/XETRA slop (Rittenhouse)
- 720[?] UnID, w/CC yelling & singing 10/7 1340-50 w/poor signal. Probably the CC HS listed here in the WRTH (Rittenhouse)
- 750^c JAPAN, Sapporo, JOIB heard u/KXL 10/7 1401-05 w/JOIB & NHK mentions by YL // JOUB. This a terrible place to DX w/murderous KCBS slop to go along w/KXL (Rittenhouse)
- 770^c JAPAN, Akita, JOUB noted here after 1200 9/30, 10/1-2, 10/5-8 usually good o/u KOB/KXA. Best 10/6 1400 w/pips, JOUB & NHK mention way o/KXA // JOBB (Rittenhouse)
- 830^c HAWAII, Honolulu w/good KIKI ID 1335 10/8 & mention of Hawaii. Not their usual R&R. Noted w/"Where Have All the Flowers Gone" 1332. Lost to unID 1338 (Rittenhouse)
- ...^c JAPAN, Osaka, JOBB noted after 1200 10/2 to 10/8. Generally my best JJ. Best 10/2 1400 w/good NHK pips + JOBB & NHK (Rittenhouse) \$ JOBB w/EE lessons 10/7 1048. Heard u/WCCO. One moment JOBB was in L&C, next moment WCCO was in L&C (Lobel)
- ...[?] UnID u/JOBB 1320-45 10/8 w/oriental singing & yelling. Sounded like what was on the 835 CC at same time, but not sure if // (R'house)
- 835^c CHINA, Nanchang noted 10/2, 10/5-8 usually w-agitated CC. Best 10/8 pegging S meter w/somewhat calmer-than-usual YL in CC 1355-1405. Missed any pips due to brief excursion to 830, but on hour a march-type musical number I've heard here before was played (Rittenhouse) "The East is Red" - & you can play it using only the black keys of the piano! (RFS)
- 840^c JAPAN, Niigata, JOJK noted 10/5-8. Best 10/5 1320-30 w/flutey-type mx // JOHK. Fade 1328 but caught NHK mention 1329 (Rittenhouse)
- 870^c JAPAN, Kumamoto // JOBB 10/7 1225-35 w/mx & JJ. NHK mentioned. This 500-kw'er getting out well w/a good signal. 1330 checkback revealed KIEV w/this still fair under (R'house)
- 872[?] UnID stn w/Oriental mx here 10/8 1356 lopping TP. Would be pretty strong w/out KIEV. Earlier noted w/a wicked het. Ideas anyone? (Rittenhouse)
- 890^c JAPAN, Sendai heard 10/2-8 usually good. Best 1400 10/4 w/NHK pips & JOHK, NHK ID's. Easily my best NHK1 (Rittenhouse)
- ...[?] UnID noted u/JOHK 10/5, 7, 8. Best 10/5 1300. This is mx which wasn't heavily Oriental while JOHK in talk. Hard to tell, but I think 5 pip arrived u/JOHK's on hour. What sort of IS doe the SK heard here have? After hour in talk in Oriental lingo (Rittenhouse)
- 1030^t CHINA? w/CC wailing 10/7 1030-40 w/WBZ. Regional stn in Kweichow listed (Rittenhouse)
- 1040^c CHINA, Shanghai noted every AM 1200+ 9/30 to 10/8. This stn an incredible powerhouse almost always pegging the meter & occasionally having an almost flawless signal for long stretches. On 10/6 at 1300 heard ID w/Peking Hoso mention by YL. Pgmng has both talk & mx, usually noted w/YL. Noticed that this stn doesn't seem quit as frantic as some CC's (Rittenhouse) My experiences of 4 years on the WC & 6 months in the FE convince me that this stn is the most powerful on earth! (RFS)
- 1178^c JAPAN, Okinawa, VOA heard 1345-1400 10/1, 2, 7, 8 w/KK. Best 10/7 w/Yankee Doodle IS & VOA Okinawa ID 1400. Seems best after 1345 w/KOFI weakened by LSR. Looping KLOK is a problem here so often all I get is a het (Rittenhouse)
- 1210^c JAPAN, Osaka JOOR heard 10/5, 7, 8. Fair 10/5 w/what seemed to be drama in JJ 1345-1400. Caught a weak JOOR & what seemed to be a single pip 1400 (Rittenhouse)
- 1475^t MALAYSIA, Sabah 10/7 1100. Barely audible w/much noise. Could just make out a faint voice that sounded exactly like the same voice heard last season on this stn. Maybe, later in the DX season I'll hear this one better (Lobel)
- ...[?] UnID noted severla AM's 9/30-10/8 sometimes w/just a carrier, sometimes w/weak talk & mx around 1230-45. Malaysia supposed to be off by then w/RK not yet on. Who? (Rittenhouse)
- 1580^c THAILAND, Ben Pachi, VOA noted 1150-1200 10/7 in EE nx pgm w/several Yankee-Doodle ID's & VOA mentions during the pgm. KDAY carrier at 1155 made things rough, but this still audible Yankee Doodle & probable Thailand mention 1200

seconds ahead of KDAY's s/on. Prize catch of the morning & my most distant reception ever. (Rittenhouse)

North-American DX Roundup

750^c ALASKA, Anchorage, KFQD fair 10/7 1050 in WSB null w/Alaska wx, KFQD ID & MoR. First time heard since last January (Rittenhouse) § A most wanted heard for first time 10/7 0630-0705. Had news 0630 followed by a "K-F-Q-D Newstime - 9:30" & a spot for a supermarket. Then had rockish MoR mx till nx at 0700. Billy Graham rel pgm at 0705 t/out. Mixed w/weak YNX occasionally, but in the clear w/good signal & 50% readable on a good Northern night (Brasier)

Trans-Antarctic DX Roundup

600⁺ ANTARCTICA. For anyone sufficiently deaf to SW DX newx, be advised that McMurdo AFAN apparently has a SW // on 6012, should your ID on 600 be uncertain (Hauser) Now I can sleep nights knowing this! (RFS)

ANZAC Summer Time Zones

Effective 3 November 1974, per Arthur Cushen's DX World (NZBC-9540), monitored by Glenn Hauser 0645 16/2:

GMT + 9	Western Australia
GMT + 9.5	Northern Territory
GMT + 10	Queensland
GMT + 10.5	South Australia
GMT + 11	New South Wales, Victoria, Tasmania
GMT + 13	New Zealand

New Zealand tries ST this summer for the first time (via Hauser)

Pan-American DX Roundup

540 COLOMBIA, Bogotá, R. Horizonte noted after XEWA s/off w/LA mx. ID mentioning Colombia but weak so couldn't copy to get a good tape. ERC & PT ID helped. No CBK 0610 9/9 (Shaftan) ERC & PT refer to Ernie Cooper & Page Taylor, both active in NRC (RFS)

... MEXICO, San Luis Potosí, XEWA 0602 9/5. In like a local w/TC & ID as LV de la América Latina or something like that. Had nx & s/off, mentions of SW freq, also mentions of Monterrey (Shaftan) A 2'nd XEWA runs 500 watts from Monterrey (RFS)

600^c COLOMBIA, Barranquilla, R. Libertad made its first appearance of the season (also first time tried, hi) way u/Rebelde in null of latter which explains my situation here. Couldn't get anything def. on this one to positively ID but gets to be fairly regular here by mid-winter. Heard 0801 9/21. All I need is a taped verie, let's see, if CMKV would go off just once, I'll (Shaftan) Richard, I don't know if this can count for the contest w/out that def. ID (RFS)

...^c CUBA, San Germán, LV de Cuba noted in so strong it was slopping over to local WVNJ when it was peaked (Cuba, that is). Had LVC ID & mentions of 15'th anniversary of revolution 0752 9/21 (Shaftan)

610 COLOMBIA, Bogotá, 14/10 0828 caught RCN SS plug u/WDAF. Quickly confirmed as Nueva Granada by // 6160v. (Hauser)

640^c CUBA, Habana, heard w/LVC 0750 9/21. In rather weak w/usual propaganda (Shaftan) § 10/7 1000 w/fast Latin mx & OM giving names of songs. Xylophone heard at 1025-29 followed by marching mx & ID as "Radio Liberación Havana Cuba Libra in América". Next - nx in SS. KFI off but on later w/OC at 1035. Was still able to hear them u/neath, however till 1039 when KFI was too o/powering (Lobel)

645^t PARAGUAY, Cnel. Oviedo. Carrier & a bit of mx below noise level 10/14 0837 (Hauser)

650 COLOMBIA, Bogotá, Emisoras Monserrate ID, MoR. Rock-steady, no QRM 10/14 0725 (Hauser)

670 CUBA, S.P. de Cacocum noted w/LA mx 0450 9/28. Nothing spectacular about this, just first time noted this season. Almost a regular here & no WMAQ (Shaftan)

670^h MEXICO, Torreón, Coah, XETOR. Polka mx pausily segué noted on 2010 at 1139 10/1. Also

found // on 670. Very likely known harmonic-ker XETOR (Hauser)

680 PUERTO RICO, San Juan, WAPA heard w/SS pgmg, mentions of P.R. In WRKO null 0103 9/10. Thanks to PT for ID (Shaftan)

690 CUBA, Habana, noted w/Cuban mx, also first time noted this season but regular in winter. Usual type pgmg 0503 9/27. Do they carry LVC? (Shaftan) No, Radio Enciclopedia (RFS)

...+ ECUADOR, Quito, Sept. 74 HCJB sked lists this instead of 700. 0900-0400 GMT SS, except Quechua at 0900-1030 & 2300-2330 (Hauser)

720 CUBA, Colón noted as usual w/powerhouse signals o/WOR slop. Cuban mx // 590, 600, etc. LVC 0510 9/27 (Shaftan)

730^t COLOMBIA, Bogotá, R. Melodía noted tentatively w/SS pgmg & LA mx. But way u/WOR slop. Has been noted before so was basis for ID 0515 9/28 (Shaftan)

... MEXICO, D.F., XEX 10/7 0745. OM + rock mx w/-QRM from CKLG. XEX played the song "Waterloo" while I was tuned in (Lobel)

760 COLOMBIA, "Barranquilla" heard o/QRM 10/14 0935. Tho consisting of only one word, I am rather certain that this logging is LV de Barranquilla (Hauser)

... CUBA, Habana 0740 10/7 heard u/a very strong WJR w/usual nx & TC's. KFMB off for a few hours (Lobel)

783^v CUBA, Camagüey 10/14 0605 & AN, SS talk about RDA. "Aquí en la Habana". No doubt RFS can provide the exact freq, but it's nice to have it that far from 780! (Hauser) Rough check shows them about right on 783 khz, +/- 20 Hz or so (RFS)

830 VENEZUELA, Los Teques, R. Sensación ID & 4:10 TC at 0808 10/14. Rock mx, 146/min (2.4 Hz) SAH w/WCCO, which was nullable. Another ID, TC 0812. Listed as 50 kw, but not often heard here (Hauser)

...? UnID in WCCO null there was some SS & LA mx. Too much WGY cross mod. to ID 0733 9/26. Everyone on channel is listed as off except Colombian, who was reported to IDXD only once in the past year. Ángel García suggests that the Dominican is running AN in this instance, which is contrary to César Objio's list in (NRC's) DXN earlier this year, so dunno. Any help? (Shaftan) The fact is that HIJB has been running AN for months now, & is assuredly your unID here (RFS)

834^c BELIZE, Radio Belize noted playing a Neil Diamond no. at 0428. Have only ID'ed by their odd freq. What is their format?? Def. a best bet for CA, 9/26 (Shaftan) Format similar to. ZNS1 (RFS) (Shaftan):

860^c REP. DOMINICANA, Sto. Domingo, R. Clarín bombing in like a local w/SS talk, LA mx, full ID at 0700 9/22. Good tape obtained altho already letter verified (actually form letter).

945[?] UnID soft Latin mx, one vocal, & YL heard here 0355 10/7. Signal weak, w/some WCFL splatter so no ID. Ecuador? (Forth) Possibly, but Honduras-944 probable (RFS)

970 MEXICO, D.F., XEDF 10/1 0705 Hora Nacional standard promo w/"en XEDF" jingle added. The Entertainer (Hauser)

980 MEXICO, Tampico, Tams., XETU, R. Tampico 10/1 0553 end Noticiario Última Hora, s/off till 6AM, next nx at 7:30 (Hauser) Cuban term is "noticiero". This all reminds me of a friendly debate: César's "apartamiento" & my "apartamento". As the song says: "Let's call the whole thing off", hi (RFS)

990^h MEXICO, Cd. Cuauhtémoc, Chih., KEER again shows on 1980 khz when QRM & ham QRM allow. 10/2 0218 rock w/heavy beat w/SS anmfs. 0314 revert ID (Hauser)

1000^{vh} COLOMBIA, Armero, R. Ambalá. Latest freq must be this, as located on 3001 khz 10/7 at 0200, 0254 ID's. 0353 3-min. fast TC, s/off, clear ID, 0355:30 off. Suffers severe QRM from VOLMET & various SS 2-way, in contrast to clear 3018 - see 1006 (Hauser) § R. Ambalá seems to have settled here, judging from harmonic still around 3000, as of 10/3 (Hauser)

1005 COLOMBIA, Neiva, R. Colosal 10/14 0938 Colombian political rx, ID // 4945. Good briefly, but then lost to KTOK splash (Hauser)

1006^{vh} COLOMBIA, Armero, R. Ambalá 3 x 1006 heard on 3018 10/1 0030 ID, 3-minute fast TC, RCN, "Actualidad Musical" pgm, best yet, SINPO 34343.

- Not heard 10/2-3 high noise level. 10/4 definitely missing, as 10/5. Finally located 10/7 on 3001 (Hauser)
- 1020^t CUBA, San Cristobal, R. Guamá dominating the channel & first taken for KSWs, 10/4 0020 political commentary on marxismo-leninismo, 0025 end, EST TC, mentioned phrase "Horizonte de Córdoba" (Quoting such a n'paper?). 0027, falling below QRM level. Guess it's R. Guamá, eh Ron? (Hauser) Sin duda (RFS)
- 1035 HAITI, Cap-Haitien, R. 4VEH. First time noted thanks to Al Brooks tip. Little WBZ or WHN QRM. Noted playing Swan Lake & other MoR instr junk (& Tchaikovsky will roll in his grave! -RFS). Faded for a while & returned with its unmistakable "Amazing Grace" s/off 0100 9/7. Early s/off (Shaftan) Let it be known that I am a Tchaikovsky fan - humph! (RFS)
- 1040^c COLOMBIA, Bogotá, R. Súper heard 9/15 0502-10 in SS w/"Radio Súper" ID's & mention of Colombia o/looped WHO (Rittenhouse)
- 1100^{ct} ANTIGUA, ZDK noted tent. w/calypso in WWWE null. Are they AN? (No - RFS) Very weak but = 3WE. Noted 0415 9/26. If so country no. 22 (Shaftan)
-^{ht} NICARAGUA, Managua 10/2 0225 very verbose, possibly borracho SS locutor, taking phone requests. EST TC's. Amid static crashes heard "La Líder en Audiencia" phrase, indicating YNQ Managua, & believe heard "Liberal" mentioned, which I believe RFS says is stn's new name. 0258 end pgm. The S.S. was Ernesto Antonio (González?). 0258:30 "hora oficial - 10 en punto", mx, s/off message, NA a slow march resembling Wm. Tell Overture. 0301 end, 0302 carrier off leaving weaker stn which has produced a heavy 250-Hz het on the high side, probably Guatemala (all this on 2200)(Hauser) Glenn, you have described "el Himno Nacional de la República de El Salvador"!! (RFS) § "YNQ Radio, La Líder en audiencia" ID after TC "en punto", 0305 10/8, s/off, NA. Excellent for a harmonic, on 2200 khz. SINPO 34454. Also 10/10 as early as 0030 35343, better than TGBA, a fundamental on 2360. ID giving 1100 khz. This early, no TGSR x2 QRM (Hauser) § Noted last season, just after the terremoto, as "Radio Liberal", w/no mention of "Líder". Now noted w/"hora Líder" TC's w/no mention of Liberal (RFS)
- 1130^v COSTA RICA, San José, R. Capital de C.R. as of 10/14 moved here instead of to 1120 from 1124-.6. Close enough to 1130 to produce a SAH, so not likely a drift. 0706 giving phone 22-56-79 for requests, CST TC's. On top of TT, other CCI, but its clear-channel days are over (Hauser) Or are they? Noted back on 1125.5 AFTER this item received, a few nights ago (RFS)
- 1140^h MEXICO, Monterrey, N.L., XEMR noted w/usual "MR" ID on 2280 khz, 1216 10/13 after switch to day pattern (Hauser)
- 1160 REP. DOMINICANA, Santiago, noted in w/Radiolandía ID's between each song as well as other times. Wish other stns were that way. Very weak KSL QRM 9/10 0311 (Shaftan)
- 1170 MEXICO, Coatzacoalcos, Ver., XEZE s/off 10/7 0557 while KVOO off but plenty of other CCI. Mentioned "Yucatán, Centroamérica" & other areas "de habla maya" just before s/off message which began "Buenas noches, Coatzacoalcos, XEZE se retira del aire ..." KVOO had run OC part of the time since 0500, but was still off at 0613, but back w/OC at 0618 check. No mention heard of R. Hit slogan (Hauser)
- 1171^h GUATEMALA, Quezaltenango, "R. Cadena Landívar" ID, TC, heard immediately upon tuning to 2342 khz 10/13 at 1159 (Hauser)
- 1180^t BRASIL, Rio, R. Globo likely the PP o/u/QRM, mentioning Niterói. Most annoying SAH was a 4-Hz one 0800 10/14 (Hauser)
- 1200^c CUBA, Santiago, Reloj Nacional recognised easily by now w/usual format, clear pips in quasi-aurora, 10/7 0023 ID, later on too. Radiotiempo assumed source of SS QRM, but no trouble de WOAI (Fader) § First time noted thanks to Eric Fader tip, heard continuous nx (I think) ticks popped thru every now & then but confirmed by tones or whatever between items. Kept getting stronger. Good tape o/u Radiotiempo 0353 9/26 in aurora (I think) (Shaftan)
-^c VENEZUELA, Caracas, Radiotiempo in o/u Cuban heard w/SS talks & mentions of YV, also LA mx.
- First time noted this season; I think that the will become a regular! Noted in WOAI null 0346 9/26 (Shaftan)
- 1220 MEXICO, D.F., XEB 10/7 0805 M&F ancrs giving several telephone numbers, then music. Several ID's heard (Lobel)
- 1265 ST. KITTTS, R. Paradise noted w/powerhouse signals slopping on to WEZE-1260 in Boston (that's strong!) In listening on & off I noted ID 0129 & each half hour & s/off 0303 after rel message (like PJB's "Thought for the Day") 9/7 (Shaftan)
- 1270 CUBA, Camaguey, Reloj Nacional noted for first time very weak w/what sounded like news. Thanks to Angel Garcia tip again. ID'ed by similar pgmg to 1200. Are they only 1000w as per my blurred copy of RFS? Heard 0601 9/28. Wasn't sure of freq tho (Shaftan)
- 1320^h MEXICO? On 2640 khz some mx briefly 1140 10/13 XERJ the only stn heard here before (Hauser)
- 1410[?] UNID strong signal dominating the freq on aural AM 9/16. 0535 w/laughing, ID as R. Tricolor. HI is the only one listed (Forth) Would concur (RFS)
-^h MEXICO, Nuevo Laredo, Tams, XEAS, R. Juventud ID, Laredo phone no. on 2820 khz 10/8 0316. This steadily on top of another fast-SAH'ing harmonic (Hauser)
- 1420 MEXICO, Tijuana, BC, XEXX 10/7 0652 no call heard but other factors, such as an 11:49 TC "desde Tijuana, Republica de Mexico ... con 2 mil watts" leads me to such an ID. Intermittent QRM de OC (Hauser)
- 1440^{ht} COLOMBIA. Here in Enid, 2880 khz is blocked by KGWA x 3 till 0405, but on later checks, such as 0619 10/4, very weak mx detectable. If R. Reloj de Tuluá, must have greatly suppressed its harmonic of last season (Hauser)
- 1460^h NICARAGUA, Jinotega, on 2920 khz 10/5 0145 an SS w/EST (or CDT -RFS) TC. 0230 ID seemed to begin w/"R. Eco del". 0308 off abruptly. Maybe Brumas is back on nominal from 1454.5 (Hauser) /(Hauser):
- 1470^h GUATEMALA, Chiquimulilla, R. Rosa on 2940 khz 10/1 1112 informal SS ancr, birthday anmts, US QRM, 1129 CST, slogan ID, mix KTDL x 2.
- 1480^{ht} MEXICO, Monterrey, NL, XEMR now back on freq, since its harmonic on 2960 khz produces a SAH w/somebody. Noted 10/13 1142 w/mx. 1206, 1209 anmts. 1211 "Oigo T-K-R" jingle (In case this isn't clear, the likelihood of a drifter producing a SAH either on its fundamental or harmonic is rather remote) (Hauser)
- 1540 BAHAMAS, Nassau, ZNS1 noted for first time w/MoR-REB pgmg. Only anmts between songs include song names but no ID's 0815-52. Not noted 0630 ca. so maybe a SP. Could someone who gets them as a pest check them?? This MM 9/9 (Shaftan) Sure not a pest here, now that they're directional (RFS)
- 1550[?] COLOMBIA? Some SS heard w/weak ID fading in-sounding like "Portelena" but not sure. LA mx. Also ID's sounding like "Radio Corobal, Quiba" or similar. I taped whole thing, so tape available for analysis (speed 15/16). 0554-0635 9/26 (Shaftan) Likely La Voz Porteña, Barranquilla (RFS)
- 1608^v NICARAGUA, Chinandega, R. San Cristóbal once varying to 1595, was heard on 10/10 & 11 around 1610 khz w/an FM'y spur. Not heard on 1595 or 1600. Carrier drops during modulation peaks, tho no def. center audible on BFO. Heard 0315 during "Música para Recorder" pgm, beginning at 9PM, no ads. Plays "Tea for Two (Té pa' ??, hi -RFS) as bridge after every selection of dance mx. 0358 ending pgm "desd los estudios de Radio San Cristóbal, buenas noches". No formal s/off beyond that, but short version of NA, followed by brief OC 035 this on 10/10. Also noted w/"Tea for Two" at 0334 check 10/11, but not detected on 10/12, 13 or 14 (Hauser)

Trans-Atlantic DX Roundup

- 683^t SPAIN, just a het, never reaching audio level in every night but at best weak audio u/wicke het (Shaftan)
- 818 ANDORRA noted w/FF talks hetting WBAP o/u & later u/Maroc on same freq. Had some piano m too. At 0500 9/7 (Shaftan)

818^c MAROC, Rabat heard 10/9 w/no sign of Andorra at all, which is unusual because I've never heard Rabat due to super-pest Andorra. Heard w/AA chanting & mx 0213. Strong, but not nearly as powerful & clear as Andorra is. Re-tune it at 0300 still found Rabat, but no Sud-Radio (Minnehan) § Noted w/AA wailing just after Sud-Radio came in o/WBAP on 820 & later o/Andorra. Some WGY slop didn't help. Thanks to RjE (Russ Edmunds -RFS) for ID on this. Only 25 kw? 0503 9/7 (Shaftan) § Again noted w/AA chants but no Sud-Radio this time. Aurora probably. Some WBAP slop too 0455 9/26. Maybe Andorra does still s/on at 0500 (see Foreign Log) (Shaftan)

- ANDORRA (revisited, sorry -RFS) Sud-Radio heard 10/10 as usual. I don't know why they weren't on 10/9. Troubles maybe? 0230. (Minnehan)
- 1016[?] TURKEY? Small het noted, but no audio, thanks mainly to KDKA, which is almost in my backyard. 10/9 0200 (Minnehan)
- 1187[?] UNID 0224 10/9 some broken audio heard weakly inside a strong European het, & no audio at all. Being right next to WOWO doesn't help. (Sorry I messed this one up, Instant Replay): ... European het. UnID lgg but not EE. Tune in at 0200 on 10/10 found about the same, but w/much more fading. 10/11 at 0200 gave only het, & no audio at all. Being right next to WOWO doesn't help. Any ideas? Perhaps Hungary? (Minnehan) RNE Spain even more likely. Again, sorry for the mess (RFS)
- 1586 GERMANY-W. Just a weak het & some light audio noted here. Like Foxy, I think that they must have done something, as in Bermuda this summer they were noted only weak, whereas last year I could hear them every night on a portable. Heard 0528 9/7 (Shaftan)

Foreign Domestic DX Roundup

- 1350 TEXAS, San Antonio, KCOR 10/1 0045 novela, interrupted by ID proclaiming its 5 mil watts día y noche. Is SS fulltime (Hauser)
- 1500 TEJAS, Merkel, KWFA 10/1 0040 tropical mx, SS, 0043 SS ID, EE s/off, SSB (Hauser)
- 1530 TEXAS, Ralls, KCLR 10/1 0100 SS ending, anced as 5-8 PM feature, EE s/off (Hauser)

Late-Arrival DX Roundup

Joe Markewicz phoned these in from Alsask, SK, on his free military land-line:

- 650 HAWAII, Honolulu, KORL MM 10/7 0730 assumed w/WSM TT (Markewicz)
- 690 CUBA, Habana, o/CBU & XETRA 10/7 0500. R. Enciclopedia ID, YL, easy-listening mx.
- 760 CUBA, Habana o/WJR 0430 10/7 Mon. eve. ID by contx. nx & beep tones (Markewicz)

Please convert dates to 10/8 above, tnx (RFS)

Thanks, all, for this 7-page (equivalent) DXWW!
73 de RFS

DXWW II 10 October 1974
Phone 317 638 4166

CHARLES TAYLOR
939 EASTERN AV
INDIANAPOLIS IN 46201

Ye ed has been corresponding for some time with Carlos Maslatón of Buenos Aires, Argentina, who is also a member of the nascent Buenos Aires DX Club. Carlos is a DXer of the SW, as well as MW. Perhaps this will come as a surprise to some of you, but apparently MW DXing does exist as a hobby down there although possibly not as independent of SW DXing as here in Anglo NA. Carlos reports reception of HJED, 820; WLAG, 1510; HOA 95, 1510; HRH6, 1340; R. Tequendama, 770; ZNS1, 1540; and R. Disco, 1500, Colombia. Also says he has verified WLAG and has a report to WCKY. Carlos mentions some interest in becoming a member of the IRCA, also.

In view of that possibility, I would like to suggest that serious thought be given to mailing the DX Monitor overseas on lightweight paper. It seems that postage becomes a very significant portion of total bulletin cost for an overseas member. Secondly, since we have assumed the name

International Radio Club of America, we should take more positive steps to see that it become even more international. Sending only DXWW to international members strikes me as a second rate compromise approach.

Carlos says (translated): 'Originally, the "y" was called "I griega" in Argentina. Now it is also called "Ye." Contrarywise to México, the "w" is called "Doble vé," rather than "Doble u."

Heto na ang balita/He aquí las noticias/
Here is the news:

JORDAN

(Plain Truth, Oct Nov 1974) King Hussein is now planning to install a two-million watt radio station at Amman, and time will be made to the Worldwide Church of God on this possibly unprecedented superpower station.

(no mention of projected freq., ed.)
Why not start a graveyard with all the superpower stations in the world on it?

(C.M. Stanbury II) SAUDI ARABIA
Saudi Arabia plans to operate from two new MW sites according to a document received from a Mid East source. At Dubai (on the Red Sea not far from Sinai) they will have two parallel million-watt xmtr's on 548 kHz and two-million-watt xmtr's on 1520 kHz. At Querayat they will have two million-watt xmtr's on 611 kHz and two 500 kW xmtr's on 899 kHz. Presumably this will mean alterations in the existing facilities on 347 at Riyadh and on 610 at Jeddah. (This should have been credited to SHORT WAVE NEWS SERVICE via Stan. Sorry for the lateness on this, Stan. ed.)

MALTA

(SCDX B1290) The Independent Broadcasting Authority Malta is on 998 kHz from perhaps 0400 to 2100 as Radio Malta No. 1. Radio Malta No. 3 has just been put on the air, intended for international broadcasts. It is now currently giving test transmissions on 755 kHz 0700 to 1000. When it has come into full operation, there will be programmes in English, French and Italian. Addr. of Radio Malta is: National Road, Plata 1-Bajda, Malta. The station is said to appreciate rec. reports on both MW stations.

BRASIL

(SCDX B1294) A number of Brazilian MW stations can be heard on their harmonic Fq's. One example is Rádio Clube de Riberão Preto, São Paulo. Their fundamental fq is 1090 kHz, but they can be heard on the third harmonic fq of 3270 as well.

BRITAIN

(SCDX B1294) IBA station Radio City, Liverpool, is to run test broadcasts prior to the start of regular transmissions by Oct 1974. The MW channel will be 1546 kHz, broadcasting with 5 kW power from Rainford. Also to use this channel, and to commence regular transmissions by Nov Dec, 1974, will be Radio Forth, Edinburgh. Power will be 1.6 kW, location Barns Farm

COLOMBIA

(SCDX B1293) Acc. to a recent verification, Radio Nacional de Colombia, Ministerio de Comunicaciones Intransivión, Bogotá, now broadcasts on 570 and 680 kHz.

COSTA RICA

(C.M. Stanbury II) A current Continental Electronic brochure reads as follows: "Continental designed and built the first super power transmitter for the Voice of America. Delivering 1000,000 watts of continuous power to the antenna, it was installed at Munich in 1953 (173 kHz, ed.) Similar Continental 1,000,000 watt broadcast transmitters are installed in Okinawa (Okuma VOA 1178, ed.), the Philippines (Poro Point, San Fernando, La Union 1140, ed) Thailand (Saraburi Prov. 1580, ed.), Central America and Egypt." To the best of my knowledge the only million watt BC XMTR to ever operate in Central America was that tested by La Voz de la Victor in the late 60's on 625 kHz (entirely without commercials), used briefly by the Christian Broadcasting Net-

work at the end of 1969 (into Jan. 19 70) and then completely disappeared from the scene. But-- even though a new, apparently much lower powered station (R. Omega) has taken over the 625 spot in San José--the Continental statement clearly implies that this super power XMTR is still installed in Central America.

Stan has broached a point that is fascinating to me: Where is the Continental 1 MW transmitter that was used by La Voz de la Victor? Has anyone bothered to write to Continental to determine if they have current information on this critter? Did any of our more enlightened members measure the frequency of La Voz de la Victor when it was using 1 MW? Currently, Radio Omega's frequency is 625,492 Hz. If R. Omega is using the Continental Xmtr excitor plus some low powered stages, as its current Xmtr, the current frequency ought to agree with that of Victor's 1 MW. If not, chances are that the two are entirely distinct Xmtrs. If they agree in frequency, there is an implication that the Continental 1 MW Xmtr was at least partially dismantled to provide material for the R. Omega Xmtr. If not, the implication is that the Continental 1MW Xmtr is unused and possibly destined for further use.

Stan realizes something that perhaps fellow Northamerican DXers do not: We cannot expect the world's governments to be as free and open with information about their respective broadcasting configuration, as the CRTC and FCC are (or even comparatively, the Mexican SCOP). Sometimes one must aggressively monitor and seek sources of information when official information is not forthcoming, or is at variance with the facts. One wades through haystacks to find the needle of truth. Often the conclusions are erroneous. We know that the CIA has its hands in many pies, and we must sometimes out-spy them. The DXista norteamericano is spoilt, with his Jones Log, his NRC map book, his NRC Domestic log, and his Broadcasting Yearbook. He often expects his foreign sources of information to reflect the truth...often they don't. I learned my lesson well researching and monitoring Sabah, Filipino and Taiwan broadcasters (not to mention the PRC) End of editorial 73 del CAT.

GERMANY, Federal Republic
(SCDX B1293) Every Sat. at 1545 there is a programme of interest to all German speaking DXers broadcast by Süddeutscher Rundfunk, Stuttgart, on 575 kHz. Every 4th Sat. you can hear the "Kurzwel-lenbummel," otherwise there is a programme of technical advice about radio reception, quadrophony, tests of recorders, etc. Recently there has been also a series of presentations of German language broadcasts in Europe with recorded illustrations, and in the near future there will be some programmes dealing with the MW reception.

GUINEA BISSAU
(SCDX B1294) When the Rep. of Guinea Bissau became an independent state on Sept. 10, the supervision of Emissora Nacional's regional station in Guinea was taken over by the PAIGC and renamed "Rádio Bissau". At the same time, the "Rádio Libera-tion" (prob Rádio Liberação, ed.) that has been operated by the PAIGC, stopped broadcasting.

INTERNATIONAL WATERS
(C.M.Stanbury II)Netherland's new anti-pirate legislation is definitely to go into effect Sept.1. R. Northsea International, Veronica, Atlantis will all cease broadcasts on or by Oct. 31. Radio Caroline says it will continue from a new anchor age but still in Northwest Europe. RNI says that after a refit it will anchor off Italy as R. Nova International named for the owner's plush Nova Parkhotel in Zurich. Provisional starting date

OCTOBER 26, 1974

for R. Nova International is Oct 13 with tests before that date.

ZAIRE
(SCDX B1294) La Voix du Zaïre is not currently using its MW frequency.

PUBLICATIONS
(SCDX B1294)A Tropical Newsletter is being published since Aug 1 by Mr. Fred Huette, Jr., 1600 Newton St., N.E., Washington, DC 20018, USA. All DXers are invited to subscribe and contribute to the newsletter. A free sample will be sent on request.

SCADS

Date: November 23, all day. Place-- Grant Manning's and John Kolb's in Poway. Map below.

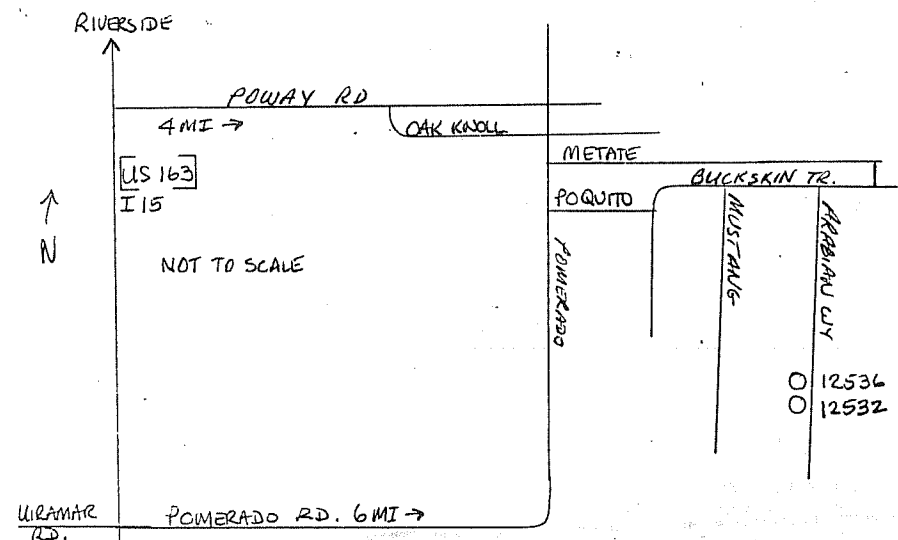

NEW YADS

(New York Area DXers)

There has traditionally been a Thanksgiving get-together in the New York area sponsored by NRC. Bring receivers, logbooks, recorders, projectors, slides, and other DX stuff if you like this year to the Mountain Motor Inn, Route 46 Eastbound, Rockaway, NJ, from Saturday, November 30, to Sunday, December 1. From noon on Saturday until 6 PM on Sunday.

Registration fee will be about \$5 a head, to pay for the meeting room. Contact the motel directly if you want rooms for the night.

Let NRC HQ know if you plan on attending so that they know how many to expect. (201-335-9182 or 201-838-5721 or Box 127, Boonton, NJ 07005).

From PA and points west via I-80-- leave I-80 at Rockaway-Hibernia exit, follow the signs to Route 46 Eastbound, take 46 for a few miles. Motel is on the right.

From NYC and points North and East via I-80-- leave I-80 at exit marked "Cherry Hill Road, Route 202, Mountain Lakes." Follow Cherry Hill Road to Route 46 west, where you turn left. Follow 46 for about 6 miles through Denville, then back under I-80. Mountain Motor Inn is on left.

From points south-- take either Garden State Parkway or NJ Turnpike north to I-287. Follow I-287 north through Morris-town to the exit for Route 46 and I-80 east. Go directly to Smith Road, and then to Route 46 west. Follow directions above as from NYC. (1 mile to Cherry Hill Road Exit.)

From New York State, western MA, and other points north-- follow Harriman (NY) Thruway to connection with Garden State Parkway south. Proceed to exit for I-80 west, follow directions above for coming from the east. OR proceed south on I-81 to its junction with I-80 and follow directions in from the west

PROVEN SPANISH RADIO
5000 WATTS SPANISH
KALI
24 HOURS A DAY
5723 MELROSE AVE., HOLLYWOOD 38-HO 6-6161

KALI - 1430...5000 WATTS
TOPS IN MUSIC IN SPANISH
LANGUAGE RADIO
24 HOURS A DAY

 Editor: Bill Hardy*
 2301 Pacific Ave.*
 Aberdeen, WA, 98520*

Special Features

DAYLIGHT SAVING ENDS OCT. 27 Congress has passed and the President has signed legislation returning the United States to standard time from 2 a.m. (local times) Sun., 10/27/74, to Sun., 2/23/75. This means that the U.S. will be back in step with most of Canada for all but two months of the upcoming DX season.

As most of you know, Congress (at the President's request) instituted year-round daylight saving time last winter during the energy crisis. DST began in most of the U.S. on 1/6/74. Hawaii, Arizona, and part of Indiana opted to stay on standard time, and Kentucky juggled its time zones. Idaho stayed on standard time (except the Pacific zone, which did go to DST) for four weeks, then decided to go on DST statewide in Feb.

The effects at that time were to make Canadian stns seem to s/on an hour later and stay on an hour later as far as U.S. DXers were concerned. Canadians found, based on the standard time they stayed on till late April, that U.S. stns were signing on an hour earlier and going off an hour earlier. These circumstances may have resulted in some new catches for a few DXers. They will return this February, when the U.S. goes on DST two months ahead of Canada.

Winter DST was unpopular in the U.S., especially in the northern latitudes, when school children had to leave for school in the dark. It also provided very minimam energy conservation - maybe as little as 3%.

One effect of year-round DST that will disappear, according to 10/14/74 Broadcasting (used by permission), is the emergency pre-sunrise authority (PSA) for a few hundred stns. The FCC had granted 50-watt PSA's (WLIB-1190 got a special 100-watt PSA so they could cover Harlem) to stns who had to stay off the air till local sunrise because of U.S. Class I-A stns to the west of them; they could use the 50-watt PSA for one hour before sunrise from the last Sunday in Oct. to the last Sunday in April. The FCC has rescinded those temporary PSA's from 10/27 till 2/23, but stns who had them will be able to use them from 2/23 till 4/27/75.

KQRX-720 TOWER DAMAGED Item from the 10/14/74 issue of Broadcasting (used by permission):
 "Authorities Friday (10/11) were investigating possible sabotage or vandalism of portion of three-element directional array that had been completed just two days before (Oct. 9) for new KQRX(AM) Las Vegas. Carl Jones, part owner of permittee Radio Nevada and principal Gauthney Jones, Washington consulting engineers, said bolts on 392-foot east tower evidently had been cut Thursday, collapsing structure. Damage was estimated at \$50,000."

The latest updated NRG Log puts KQRX on 720, 50 kw-D, 10 kw-N, DA-N (U2). No address given except for Zip Code 89101. KQRX is the second-last Class II-A assignment to be made on 11 U.S. II-A channels made available for powerful West Coast operations in the early 1960's. The only remaining II-A channel is 890 kHz for assignment in Utah, and early this year, competing applications were filed by KDXU-1450 and another applicant for St. George, Utah on 890, so that will take a hearing to straighten out.

Meanwhile, KQRX-720 should be on testing soon, and after that, they'll be on RS within a few months. Better DX on 720 while you still can! -BH.

KAAY-1090, TWO OTHERS BEING SOLD IRCA Special Features does not report every little sale announced or approved by the FCC, since in most cases the stns format and facilities change, and you get 30 days' notice of any call letter changes anyway. However, we like to let you know about sales involving some of the 50 kw stns (which obviously are bigger DX targets, as well as familiar to a lot more of you).

Oct. 7 and 14 issues of Broadcasting (used by permission) report the sale of three AM and an associated FM stn by LIN Broadcasting Corp. to Multimedia Inc. The three AM's being sold are KAAY-1090 Little Rock, Ark., 50 kw, DA-N (U2); KEEL-710 Shreveport, La., 50 kw-D, 5 kw-N, DA-2 (U4), and its sister KHEQ(FM); and WAKY-790 Louisville, Ky., 5 kw-D, 1 kw-N, DA-2 (U4). Multimedia owns WFBC-1330 (plus FM-TV) Greenville, S.C.; WBIR-1240 (plus FM-TV) Knoxville, Tenn.; WMAZ-940 (plus FM-TV) Macon, Ga.; WWNC-570 Asheville, N.C.; and WXII(TV) Winston-Salem, N.C. LIN has contracted to buy WBAP-TV Fort Worth, Texas, and is keeping WBBF-950 (plus WBFB, FM) Rochester, N.Y.; WFIL-560 Philadelphia, Pa.; WIL-1430 (plus KFMS-FM) St. Louis, Mo.; KILT-610 (plus FM) Houston, Tex.; WAND(TV) Decatur, Ill.; and WAVY-TV Portsmouth-Norfolk-Newport News, Va.

Whether Multimedia changes anything or not remains to be seen. If you see anything about format changes, call changes, change in hours of operation, or anything like that in your local newspaper, if you live in the Little Rock, Shreveport, or Louisville areas; or if you hear any format or hours change - why not mention it in a Forum report? And any definite changes should go to the DXR's tool! -Bill Hardy.

WMAQ-670 MAY GO COUNTRY A record industry trade publication suggests that WMAQ, NBC-owned 50 kw outlet in Chicago, is gearing up for a format change to country music. Chicago's major country-music outlet presently is WJJD-1160, limited-time 50-kw-DA stn operating from Chicago sunrise to KSL sunset, which has a country FM stn also. WMAQ was still using a pop-rock format on 8/18, but if you start hearing C&W on 670 kHz, don't think that WSM is off frequency! -BH.

80

IRCA INTERNATIONAL RADIO CLUB OF AMERICA
 12536 Arabian Way, Poway, CA 92064

USAirmail

14
920

David Williams 17A
 Box 615, Hwy. 101
 Astoria, OR 97103

THE INTERNATIONAL RADIO CLUB OF AMERICA-- a non-profit club devoted to listening to distant radio stations on the broadcast band (540-1600 kHz). IRCA is a member of ANARC, the Association of North American Radio Clubs, dedicated to promoting cooperation between the radio clubs of North America.

IRCA Officers: President: Richard C. Evans, Box 392, New Buffalo, MI 49117. (616-469-3866). Secretary-Treasurer: Carl Dabelstein, 3300 North 56th St., Lincoln, NE 68507; Board of Directors: Father Jack Pejza (Chairman), Bob Foxworth, Nancy Hardy, Percy Kesteven, Ed Krejny, Bill Nittler, John Zondlo. Membership dues in IRCA: \$2.00 per year.

IRCA publishes the IRCA Foreign Logs, listing over 1500 foreign stations heard on the broadcast band from North America. Volume I, \$2.25; Volume II, \$3.00. Combination offer, \$5.00. Volume 3 available shortly.

IRCA has an extensive list of reprints of articles and features which have appeared in DX Monitor in past years. Send a self-addressed stamped envelope for a copy of the list.

IRCA stationery: 70 sheets for \$2.00; 100 sheets for \$2.75. Rubber stamp of club emblem, \$3.00. Permission is granted to publish, broadcast, or reproduce any of the material in DX Monitor (except items which acknowledge that they appear by permission from other sources, or material which is copyrighted), provided credit is given to DX Monitor and the author or contributor, if listed.

DX Monitor is printed by Vanard Lithographers, San Diego, CA.



DX MONITOR SUPPLEMENT

VOLUME 12 NUMBER 6 NOVEMBER 2, 1974



DX CALENDAR DX CALENDAR DX CALENDAR

All times Eastern Local Time

Mon. Nov. 11	0205-	WTAW	1150 Bryan, TX	1 kw D1
	0230-0300	KDLT	540 Delta, UT	1 kw D
	0300-0330	WTKM	1540 Hartford, WI	.5 kw D1
	0300-0330	WCSJ	1550 Morris, IL	.25 kw D1
Fri. Nov. 15	0000-0100	WERA	1590 Plainfield, NJ	.5 kw D3
Mon. Nov. 18	0300-0330	KRMO	990 Monett, MO	.25 kw D1
	0400-0440	KTLK	1280 Denver, CO	5/1 kw U1
	0500-	KQXI	1550 Arvada, CO	10 kw D1
Mon. Nov. 25	0200-0300	KFUO	850 St. Louis, MO	5 kw L1
	0300-0330	KPUB	1480 Pueblo, CO	1 kw D3
Mon. Dec. 2	0200-0230	KNEL	1490 Brady, TX	1/.25 kw U1
	0300-0330	WHBN	1420 Harrodsburg, KY	1/.5 kw U1
Tues. Dec. 3	0645-	KRME	1460 Hondo, TX	.5 kw D1
Fri. Dec. 6	0000-	WJKL	1310 Asbury Park, NJ	1/.25 kw U5
Mon. Dec. 9	0330-0400	KGST	1340 Jackson Hole, WY	1/.25 kw U1
Mon. Dec. 16	0230-0300	KBWV	1560 Blue Earth, MN	1 kw D1
	0300-	WSLT	1520 Ocean City, NJ	1 kw D3
	0330-0400	KPOC	1420 Pochantas, AR	1 kw D1
Mon. Dec. 23	0400-0500	KCNO	570 Alturas, CA	5 kw D1
	0500-0600	KAFY	550 Bakersfield, CA	1 kw U2
Mon. Jan. 6	0100-	WMLO	1570 Beverly, MA	.5 kw D3
	0200-0400	WIMS	1420 Michigan City, IN	5 kw U4
	0200-0550	WACE	730 Chicopee, MA	5 kw D1
	0245-0305	WGOM	860 Marion, IN	.25 kw D3
	0300-	WAAB	1440 Worcester, MA	5 kw U4
Mon. Jan. 20	0130-0200	WFAW	1470 Farrell, PA	1 kw U2
Mon. Feb. 10	0100-0200	WGIL	1400 Galesburg, IL	1 kw U1

WTAW-- erroneously reported earlier as 11/9. No program details. Send reports to Antone J. Nemecek, WTAW, Box 3008, Bryan, TX 77801. (Actually listed in NRC Log as College Station, TX). Arranged by Larry Ledlow, Jr. for NNRC.

KDLT--no program details. Verie signer will be Glen S. Gardner, GM, KDLT, Box 327, Delta, UT 84624. Arranged by Skip Dabelstein for NRC.

WTKM--no program details. Write Richard Feutz, CE, WTKM, 27 N. Main St., Hartford, WI 53027. Arranged by Skip Dabelstein for NRC.

WCSJ-- no program details; tone requested. Write Bob Cooper, CE, WCSJ, Box 270, Morris, IL 60450. Arranged by Skip Dabelstein for NRC.

WERA-- reports go to WERA, Tri-County Broadcasting Corporation, 120 West Seventh St., Plainfield, NJ 07060. Arranged by John W. Eckerd for NNRC.

KRMO-- tone requested. Jim Helmkamp, CE, will be at the mike. V/s will be Floyd V. Stewart, Manager. Write to KRMO, Box 270, Monett, MO 65708. Arranged by Skip Dabelstein for NRC.

KTLK-- will use tones of various pitch and modulation; announcements will tell percentage of modulation and exact number of cycles per second. From 0400-0410, will use 5 kw on night pattern; 0410-0420 1 kw with night pattern; 0420-0430 1 kw non-directional pattern; 0430-0440 250 watts with non-directional pattern. Night pattern is mostly due north; major attenuation are at 55°, 115°, 165°, 235°, and 290°. Announcements will also include power used during that interval. Correct reports will be verified. The station requires information from voice announcements, such as words, phrases, etc. for verification. No veries will be issued just for reception of tones. Return postage must be included. QSL cards will be signed by Chief Engineer Ron Kashner and will include date, time, power used at the time, and antenna pattern used. Reports should be as detailed as possible, with interference, propagation conditions, type of receiving antenna; SINPO or SIN codes are okay. Brad Hart, Transmitter Engineer is an IRCA member. Arranged by Rob Harrington for IRCA.

KQXI-- no program information. Reports go to Lloyd Allen, Chief Engineer, KQXI, P.O. Box 504, Arvada, CO 80001. Arranged by Daniel Levine for NNRC.

To make CPC information gets into the first possible bulletin, send CPC info directly to Father Jack Pejza, 3266 Nutmeg St., San Diego, CA 92104. Sending it to Poway could mean a delay of a week in getting it into the bulletin.

BROADCASTING

INFORMATION

(as compiled by Mike Worst)

KATQ	940	1-D	Texarkana, Tex.	requests KADO
KKYN	1090	1-D	Plainview, Tex.	start operation
KBER	1150	1-D	San Antonio, Tex.	requests KKSA from KSAZ
WHQY	1210	1-D	Salinas, P.R.	to 1-U DA
new	1220	1/2-D	Whitley City, Ky.	CP
new	1230	1-D	1/4-N Steamboat Springs, Colo.	CP
KXLW	1320	1-D	Clayton, Mo.	to 5-D ND
WLCB	1430	1/2-D	Buffalo, Ky.	to Buffalo-Hodgenville
KEDI	1490	1/2-D	1/4-N Manitou Springs, Colo.	granted KIIQ
new	1510	1/2-D	Pageland, S.C.	granted WPSC
KCAW	1510	1-D	Port Arthur, Tex.	" KYKR
KBBQ	1590	5-U	Ventura, Calif.	to Ventura-Oxnard

From the Oct. 14 and 21 issues of Broadcasting.

Geomagnetic Indices

Oct. 16-22 40 39 32 21 30 8 15

Radio conditions should have been quiet through Oct. 27 and then unsettled in association with increased geomagnetic activity. The next period of significant disturbance is expected to be 9-14 October.

CPC Results and FLASH TIPS..

KGHO test on Oct. 21 was heard in San Diego with fair voice announcements and code IDs, plus rock records.

KHYM test on Oct. 28 not heard with KUPD on instead. **KAMA** f/c appeared at 0200 for four minutes with voice IDs and tone. Announced as 10 kw. NRC Log says 1 kw.

Bob Foxworth reports Radio Caaguazu-645 was in Monday morning 10/14 0630-0700 UT with a nice signal.

Mort Meehan has received verification of **KORX**=720, Las Vegas, NV, presently concluding its three-year construction permit with final checks on its transmitter in Henderson, NV, 15 miles east of LV. At present they are operating with 50 kw non-directional days, 10 kw directional nights, with major lobe towards Los Angeles. Mort noted they had open carrier most days during September, but he hasn't heard them at night yet, and no trace during October. They arrive at Yecca Valley, CA on a par with **KMPC**-710 and louder than the other Las Vegas station--1140--heard in daytime.

The Inside Story

President's Report--Rick Evans
Easiest to Hear From--DC to Idaho
DX Records
DXer of the Month--Al Ogrizovich
No Central DX Forum--no reports according to John Zondlo

Last issue wasn't mailed until Tuesday, Oct. 29. With our first-class permit to mail without stamps, we have to deposit the bulletins in the Weighmaster's office, which closes at noon on Saturday; we didn't finish assembling the bulletin for mailing by then; hence the delay, since the P.O. was closed on Monday. Hope you got it by the weekend.

eastern dx roundup

CAROL SCHWEIGER
55 TALBOT AVENUE
STRATTON HALL, Box 58
TUFTS UNIVERSITY
MEDFORD, MA 02155

540 CBEP ON Windsor; good o/u XEWA 9/27
2359 w/"Ici R. Can.", FF nx.(EDF)

560 WHYN MA Springfield; good w/rr mx, ID u/
WFIL's nx, 0020 10/6.(EDF)

580 ???? ?? unID; w/SS nx, mentions of Can!
(?) 0000-0006 9/28, then SS mx.
Who?(EDF)

600 WCAO MD Baltimore; most-wanted hrd.W/rr
mx, IDs w/Cuban nulled, 0430-
0445 10/10. WTAC QRM.(EDF)

WTAC MI Flint; u/Cuban & HJHJ @0010 9/28
w/rr mx after WICC s/off.(EDF)

WVAR WV Richwood; Fair w/local spot 0609
9/28.(SF)

680 CFTR ON Toronto; local strength (altho
pattern shows no power this way)
0000-0005 10/6 w/rr, IDs. In
well 10/8 too. (EDF)

710 WBBX VA Blacksburg; hrd @0741 on 9/30 w/
c&w mx and wx, fair signal, new.
(JAD)

770 KOB NM Albuquerque; strong after WABC
fadeout 0615-45 8/26 w/c&w mx &
numerous spots for truck stops.
(SF)

790 WPAR VA Norfolk; in well, assumed before
pattern change-9/30 1911 w/ID &
MoR mx.(EDF)

800 *KDDD* TX Dumas; good on test w/music & ID
in CKLW null 0205 10/14.(SF)

910 WRCH CT New Britain; WRCH, formerly
"Rich Music" has changed format
from beautiful music to rock/
oldies, using "91-Q" as an iden-
tifier.(Pv)

920 CKCY ON Sault St. Marie; ID u/WJAR, 'PAT
slop 10/6 0029.(EDF)

950 WWJ MI Detroit; w/"WWJ nx-time 5:42(am)
10/10, w/wx.(EDF)

960 *WELI* CT New Haven; 9/23, ID 0053 in midst
of ET-TT-mx, only logging in
otherwise totally "blah" morning
(TRS)

990 KTKT AZ Tucson; Surfaced briefly u/XET &
WIBG OC w/rr mx & ID 0314 9/9.
Believe they were also the one
w/two-man discussion program
0250. Local WNOX taking their
first AN SP in nearly 2 years.
(SF)

1070 WKMB NJ Sterling; 9/19, shortest s/off
ever hrd, at 1900..."At this time
WKMB concludes its broadcasting
day. Good night." (TRS).

1090 WGOE TN Kingsport; hrd at 1944 on 9/29
w/s/off, no SSB hrd, announced
50 watts PSA power, poor, new.(JAD)

WKFI OH Wilmington; noted on w/new call
letters at 1935. On 9/29, c&w mx,
local nx, s/off at 1945, formally
WMWM.(JAD)

1140 CBI NS Sydney; Fair but fady "O Canada"
poking thru jammer 0447 9/9,
followed by s/on & into John
Denver disc. Canada #50 here,
but first maritime.(SF)

KLPR OK Oklahoma City; Fair o/CJTR w/
brief IDs 0450 + 0451 10/7 on
presumed OC ET.(SF)

1160 WJJD IL Chicago; w/s/off 2145 9/22.
This isn't their usual s/off
time, is it? Seems sorta late.
(EDF)

1220 ???? ?? unID; FF 2005-2015 w/EE rock at
times, 9/7. Most likely CKSM.
(EDF)

CKCW NB Moncton; o/u WGAR null 2004-
2030 9/7 w/rr mx, good ID 2018,
EE. unID FF-talking EE-rocker
under.(EDF)

WPAX VA Falls Church; occasional SSB'er
noted w/powerful sig, 1911-1915
s/off. Wx 1912, Salvation Army &
local promos, then into s/off
1914.(EDF)

WLSD VA Big Stone Gap; hrd at 0730 on
9/30 w/c&w mx program sponsored
by Firestone Rubber Co., new(JAD)

1230 WERI RI Westerly; is a day reg. here.
(EDF)

WKBO PA Harrisburg; 0027 10/5 ID u/WPAS.
New. (EDF)

1240 WDUN GA Gainesville; 9/15, w/ID 0004
following a record, ex level
for tape file, new.(TRS)

WRTA PA Altoona; u/WGBB w/ID, then nx
1859 10/9. New. (EDF)

1250 WYSR VA Franklin; weak but atop w/s/on-
SSB 0600 10/12.(SF)

1260 KGBX MO Springfield; poor u/WNDE/WNDR
w/25-inning Cards marathon fol-
lowed by replay of a Spring-
field-Montgomery (Ala.) game AN
9/12, for #1600 heard in 4 yrs
on \$28 portable w/no antenna.
(SF)

1310 *KF3B* MO Joplin; "KF3B Joplin" out of
nowhere on presumed OC ET 0128
10/7; fair o/WIFE/CPGM.(SF)

1320 *WILS* MI Lansing; 10/6 atop channel w/ET-
mx; ID 0501.(SF)

1340 ???? ?? unID; s/off 0005 9/15, no SSB.
(EDF)

WTRN PA Tyrone; on top 1845 10/9 w/"Rock
Me Gently", former #1 record.
1st time got pos. AM ID.(EDF)

1350 ???? ?? unID; s/on w/SSB 0614 10/10.Prob
few sta's would s/on at that
time; help anyone?(EDF)

unID; garbled call given 0511
10/10 w/mentions of "in the
public interest... 24 hrs a day"
Nothing similar listed, prob. a
mis-ID in severe QRM.(EDF)

1360 WWBZ NJ Vineland; one of my "closest un-
hrds" hrd w/ID in mess 0524 10/
10, u/WDRG & unID SS.(EDF)

1370 WELV NY Ellenville; most-wanted daytimer
hrd 0636 10/10 w/wx, "42 at Mon-
ticello".(EDF)

WKMC PA Roaring Spring; good o/u WSPD w/
s/on SSB 0600 SM 9/29.(SF)

1400 WALE MA Fall River; 0526 10/10 w/rr oldie
preceded by jingle "WALE...
remembers." New.(EDF)

1430 WENE NY Endicott; w/rr mx 10/8 1935-1953
in WNJR semi-null, o/u CKFH's rr
mx. Very rare here.(EDF)

1450 *WROB* MS West Point; r/c ending with ID
0407 9/25. Unique modulation (
telephone busy signal) really
helpd this one stand out.(SF)

1530 KJEM OK Wagoner; good u/WCKY w/111 watts
PSA s/on 0701 8/31, no SSB.(SF)

KNIE WY Cheyenne; noted ending nx 0205,
into Beatles "Good Night" fol-
lowed by s/off-SSB 0209 9/16.
Weak to fair signal u/an un usual-
ly strong KFBK & mysterious het.
(SF)

WBCW PA Jeanette; noted on 9/22 1917-30
s/off w/oldies r&b type mx & one
local clothing store spot. Hys-
terical laughter preceded s/off
ann. Severe WCKY QRM & fading.
(GWJ)

WMBT PA Shenandoah; newie hrd w/s/off
1914 9/12. 'KB, WRCP slop, unID
rr(WCTR?) QRM.(EDF)

WPWC VA Quantico; weak u/WCKY 0600 10/3
w/s/on-SSB preceded by rooster
crow.(SF)

WRBX NC Chapel Hill; newie ID'd at 1929
s/off following rel mx, WCKY QRM
'KB slop, QRM.Easy,hi.(EDF)

1540 WPTS PA Pittston; hrd way u/WNBC-WCBS
image w/WRCP & WPTR to complicate
things, w/s/off ancts 9/22 1913,
then SSB as it faded into the sun-
set,hi. Lousy signal.(EDF)

1550 ???? ?? unID; w/Stevie Wonder rr mx u/ WVAB 1911, 9/27. Possibly WEXT below.(EDF)
KEDD KS Dodge City; fair o/KKHI on ET w/c&w & ID 0118 MM 9/16.(SF)
KQXI CO Arvada; local strength on quicke ET 0300-0304 10/?; instrumental MoR w/ID 0304.(SF)
WBVM NY Utica; s/off sorta late 1929 9/29. 2 IDs hrd pretty clearly on wrhc tape.New.(EDF)
WDLR OH Delaware; 9/25, s/off w/o SSB noted 1945 thru CBE, fair sig. New. (TRS)
WEXT CT W. Hartford; o/u WVAB @1900 9/27 w/mentions of Hartford.New.(EDF)
WKVA VA Vinton; newie hrd easily w/2 IDs right sfter WRHC s/off, 1930 9/29. Power & FCC ancts picked out of tape as well.(EDF)
WKVA VA Vinton; good w/s/off ancts 1843 10/9.(Pest WVAB's s/off this month 1830.) (EDF)
WRHC FL Coral Gables; w/unbelievable signal, 1923 & up 9/29. SS mx to SS s/off 1927, followed by EE s/off. Fades slight, no problem. Taped.(EDF)
WTYN NC Tryon; w/mention of studios, on very productive WRHC tape! 9/29 1930 s/off.New. (EDF)
WVAB VA Va. Beach; Exceptionally good 1900-1915 9/27 w/many IDs & jingles. Wx 1905, then soft vocal mx.(EDF)
1560 *KRCB* IA Council Bluffs; ET good o/KKAA w/Neil Diamond records 9/19; final ID & CDT TC 0306.(SF)
WBKC OH Chardon; strong on ET w/MoR/TT/OC 0202-13 9/27, brief ID 0208.(SF)
WTNS OH Goshocotn; SSB 0559 9/19 had the channel to itself, but AM-FM s/on was rough going u/WQXR.(SF)
1570 CFOR ON Orilla; on top o/CKLM, etc w/song"Life is a Rock, but the Radio rolled me" 2216 10/8.Also w/end of rel prgm, wx & nx @0558 10/10.(EDF)
WKOL NY Amsterdam; cpl call-freq-city ID, & "country KOL" ID, w/c&w mx. This 0624 10/10.(EDF)
WPEP MA Taunton; tuned in right after s/on, hrd many messy IDs 0532 10/10. From what QRM sounded like "WFCU", to give an idea of the IDing difficulty, hi.(EDF)
1580 *WCRV* NJ Washington; 9/15, ET-OC-mx, ID 0103, atop freq! (TRS)
WHEX PA Columbia; 9/12 1905 w/"Hex R. Nx-watch."(EDF)
WSRF FL Fort Lauderdale; hrd at 0320 on 9/24 w/tones on this equip. test porr-fair, new, ID at 0325.(JAD)
WSRF FL Fort Lauderdale; hrd 9/15 2002 & up w/rr mx, incredible signal altho torn up by WQXR whistling het 1579.5."Surf IDs, mention of a "special prgm at 10:30" Disappeared 2029-this was not a fade! Sounded like a cut carrier was this a DX test? Def. not semi-local WSUF. Any insight? (EDF)
1590 WCBG PA Chambersburg; 1916 9/12 o/u QQ, w/Monkees mx, good ID.(EDF)
1600 WTYM MA E. Longmeadow; ID emerging from u/WWRL rel prgms 1858, w/another (unID) sta.One of 'em (prob. WTYM) s/off 1900, left the other (at least momentarily) on freq. who could the other have been? Doubt WLNG...(EDF)
WUNR MA Brookline; exc. signal u/WWRL 9/25 2355 w/nx, soul(?) mx.(EDF)

(SF) Stephen Francis/1620 Lodge St/Alcoa, TN 37701
(GWJ) George W. Jensen-4604 Anntana Ave/Baltimore MD 21206
(PK) Pete Kemp/13-B Fleetwood Ave/Bethel, CT 06801
(TRS) Thomas R. Sundstrom/Box 205/Willingboro, NJ 08046
#####
Nice size column this week. Glad to see that there are some people out there still DX'ing!One thing I would like ask: If there are any test per the list that you send in, please separate these from your other catches. And, I'd appreciate it if you could star the ETs, as you have done in the past. Well, keep up the great support. 73's and GOOD DXing. Carol.

central dx roundup

Editor: John C. Kelscher, Box 7543, Fairfield Stn. Fort Wayne, IN 46807

A HAPPY HALLOWEEN TO ALL IRCAers FROM YE EDITOR AND:

DRW - DON WEINZIERL, 6100 W. 97th, Oak Lawn, IL 60453 (Halli SX-42, SM-1)(Sorry, almost missed one of yours last week, see 1410)
GBS - GEORGE SHERMAN, 104 Pinewood Circle, Rosemount, MN 55124 (Rx??)
GEP - GEORGE PAETZMANN, 7507 Jefferson Ave., Hammond, IN 46324 (Realistic DX-160, SM-2)
JAM - JOE A. MARKEWICZ, CFS Station Alsask, Alsask, Sask. SOL OAO (Rx??)
RSK - ROBERT KRAMER, 3406 W. Pierce, Chicago, IL 60651 (HQ-129X, 4' x 3' spiral loop)
- MICHAEL HOGAN, 4811 Euclid Avenue, East Chicago, IN 46312
GH - GLENN HAUSER's MW DX REPORT (DOMESTIC) compiled 14/10/74 at 1312 West Oak, Enid, OK 73701 EDT attempted kHz Rx: HQ160; Ants: SM2 (preferable, up to 1.7 MHz, and necessary below 1.32 MHz); NW/SE and longer NE/SW longwires. Reproduction without individual credit prohibited. (sic)
PB - PHIL BOERSMA, 15570 Cleveland St., Spring Lake, MI 49456(Panasonic RF-1600, 60' LW)
GRB - GEORGE BERTONZ, 9515 So. Kilbourn Ave., Oak Lawn, IL 60453 (HQ-180, SM-2)

TRICK OR TREAT !

1600 WLLS KY Hartford, s/on strong, very little QRM, 0700 SM 10/13(GBS)
WKWF FL Key West, 10/4 0139, in poor with Nx (RSK)
1590 WLFA GA Lafayette, s/on w/Dixie, strong, way o/QRM 0600 9/17 (GBS)
1580 KGAF TX Gainesville, AM & FM s/on, no SSB, good, way o/QRM 0800 SM 10/13. Never hrd on SSS (GBS)
WAXU KY Georgetown, weak in mess w/ID, 0730 SM 10/13 (GBS)
WCNB IN Connersville, 10/8 0745, with vocal SSB and s/on (RSK)
1570 WYTI VA Rocky Mount, s/on w/SSB 0600 9/17 u/500kw XERF (GBS)
CKTA ALT Taber, new station first heard evening of 10/11, fair days and nites with interference from XERF, CHUB (even as late as 1100), simulcast CHEC-1090 nites (rock) with local programs starting around 0900, pop, country, local flavouring, "10-90 Check in Southern Alta" IDs. Taber 35 miles from Lethbridge, 40 miles from U.S. border, 140 from Alsask (JAM)
1560 KKAA SD Aberdeen, poor to fair with KPNC QRM, not much better after KPNC s/off, lots of fading. I get a better signal from KOTA-1380, KELO-1320 or even KS00-1140. Hrd 10/9 0100 (JAM) MM SP is 0115-0600 (GBS)

#####
BROUGHT TO YOU BY:
(JAD) Jim DeYoung/1514 Greenbrier Dr./Huntington, WV 25704
(EDF) Eric Fader/23-35 Bell Blvd/Bayside, NY 11360

WTNS OH Coshocton, s/on w/SSB, good over WDXR (X-rock 15) 0600 9/12 (GBS)

KQYX MO Joplin, fair 1933-34 o/WDXR/WQXR w/ads ment. Joplin (PB) (You don't give date, I spell wrong-Ed)

1550 WXVA WV Charlestown, in poor u/mess with SID, 0651 9/30 (RSK)

(Note: ye editor would like to have punted this week, but in the interests of info...)

KLFJMO** Springfield, another MO on 1550, new station hrd ETing 0200-15 10/21, 500w daytimer w/gospel format, calls "Keep Looking For Jesus." Voice mostly readable thru Mx from KGMO ET and KKJO, who ended ET 0204. KLFJ expects to be on RS in a couple of weeks "from the Land of a Million Smiles, the Ozark Area of S.W. Missouri" (JCK)

KGMOMO** Cape Girardeau, 10/7 on test with R&R, jingles, sounded like RS, not listed as f/c (PB) (Time?-Ed)

WYNXGA** Smyrna, 10/13 1232-0111 w/ET, fair u/o KKJO, IDs 1245, 0110

1540 WPTS PA Pittston, 9/29 0607, //(GRB) poor u/KXEL, MoR Mx and ads(JDF)

KZRK AR Ozark, fair 10/13 1930-45 o/very weak KXEL with R&R to s/off with "America" 1945 (PB)

1530 KJEM ?? 10/13 0716-30, in exlnt, no sign of WCKY, w/15 mins of religious Mx, then jingle, "KJEM, 1-5-3-0, playing it." Call definitely hrd right, got a good tape of 'em. Any ideas? I have no listing for them (RSK)

KMAH MO Butler, 10/14 0729, in fair o/u WCKY w/promo, 168 watt psa (RSK)

WKDC IL Elmhurst, 10/12 1155, w/MoR Mx, Ai Nx 1200, upbeat pgm 1210, exlnt signals, slight WYGR QRM, IDs as "The Beautiful Way to spend your day, W-K-D-C" (JDF)

1520 KYXI OR Oregon City, MoR and ID w/WKWB 0410 MM 10/7, best bet for OR (GBS) For those out east, fair to good eves u/KOMA, all alone MM with KOMA off. Hrd 0230 10/7

1510 CKOT ONT Tillsonburg, 10/5 0656, //(JAM) in fair-good w/spot (RSK)

1500 WTOP DC Washington, s/on 0502 10/14 under KSTP OC and LA QRM (not KERH), not an easy catch out here (GH)

1490**KXRA**MN** Alexandria, tentative, think this was their f/c hrd 0130-2000 10/14, no ID, fair u/WOPA and others (JDF)

CPHG BC Holberg, operates with 20 watts, carries CBC programs plus local stuff for the Armed Forces (JAM)

CFWB BC Campbell River, good w/s/off 0401 10/7, seemingly // to 1440 (JAM)

KARV AR Russellville, good w/KLNG QRM on f/c w/code IDs, and voice ID at end, 0600 Weds. 10/2, listed 2nd Weds., list change? (GBS)

1480 WGSB IL Geneva, 10/14 1020-30, stations signals very weak, first time heard after 3 years of trying.

WABB AL Mobile, on and off 0040-0131 10/7, R&R Mx, high blood pressure PSA, was local strength but must have had xr trouble, kept going on and off in the middle of sentences and ID's, like somebody flipped a switch, occ. slight WYZE QRM (GEP)

1470^h KTDL LA Farmerville, on 2940 harmonic 0742 10/13 w/ID and temp., QRM probably from Guatemala. KLCL used to be the dominant 1470 harmonic (GH)

1450 WPAR WV Parkersburg, 9/28 0301, good thru WVON w/Listeners' Comment program and promo (RSK)

WDAD PA Indiana, fair thru WVON w/SSB then s/on, 0559 10/6 (RSK)

WMOH OH Hamilton, very clear o/QRM w/R&R, 2007 10/12 (GBS)

1440 CFCP BC Courtenay, poor w/s/off 10/7 0401 (JAM)

1420 KTOE MN Mankato, off MM's 10/7 and 10/14, only weak SS hrd (WHK reg. MM SK now?). Will wait to decide if KTOE stopped NSP, as KYSM (competitor) still on MMs (GBS)

1410 CFUN BC Vancouver, 10/7 0350, very good on beautiful N.W. opening, some WING QRM (DRW) S-9 +35 db MM 10/7, w/R&R, no QRM, ID "Color Radio One, C-Fun," dominates most mornings, best BC signal (GBS)

1400 WSGA GA Savannah, 10/14 0240, in fair w/Nx u/UnID TTer, got a tape and report (RSK)

CINL BC Princeton, good with news, sports read by Jerry Whitehead 0255, 10/7, s/off 0306 w/vocal 0 Canada, part of the "NL Network," (CJNL-1230, CHNL-610) operated by them but owned by local interests (JAM)

1390 WTOO OH Bellefontaine, 10/10 in fair at s/on, WNUS off. Do they verie? (RSK) (Time?-JCK)

1380 WYSH TN Clinton, 9/28 0656, in fair with spot (RSK)

WLRO OH Lorain, 9/28 0651, fair w/Wx (RSK)

WMEE IN Fort Wayne, MM SP is 0200-0500 EST (on till C300 EDT) (GBS)

WLCYFL** Saint Petersburg, on ET w/R&R Mx and IDs after every song. IDs as WLQY and Super LQY. Why WLQY when call is WLCY? In like a local from 0230-45. 0245, jingle as WLCY and s/off. This one really bugging me, anyone know what's going on? (JDF) (I would guess, Jay, that their FM outlet is now WLQY, and they pull the audio off the FM for their AM testing. Un-bugged? Ed.)

1370 KDAN MN South Saint Paul, now all Nx (GBS)

KDTH IA Dubuque, s/on now 0600, ex-0630

WCOA FL Pensacola, tuned in //(GBS) to SSB 0108 and figured "I lost that one," but after SSB was "WCOA is protected by Southern Patrol Service," then carrier off, good 10/14 (JDF)

CHPQ BC Parksville-Qualicum, good here mornings after KXLE s/off, all alone and should make it further east than this (JAM)

1350 WXCL IL Peoria, w/light Mx and ID, u/WIOU 1313 10/6, fair (JDF)

WGAD AL Gadsden, 10/12 1949-2014, R&R Mx, bulletin board, spots, UPI Nx, and SEC FB at 2014. Good signal, little QSB, slight QRM from WIOU (GEP)

1340 KLBK TX Lubbock, good w/QRM 0308 MM 10/14 w/TT and ID, "on the air for xr maintenance" (GBS)

WMID NJ Atlantic City, 10/7 0354, fair w/Nx (RSK)

KHUBNE** Fremont, think this was the one with tones and OC on r/c. No definite ID heard but time is correct, 0130-45 10/14 (JDF)

WEKY KY Richmond, 10/4 0201, poor with s/off (RSK)

WIGO GA Atlanta, 10/13 0449, in fair with ID, got tape but no report (RSK)

KQIL CO Grand Junction, good o/QRM 0310 MM 10/14, "All American Country, 24 hours a day" (GBS)

KDEN CO Denver, is SP, MM 0200-0700 (GBS)

1330 CKKR SAS Rosetown, good days, but suffers heavy KFH, WLOL QRM nites. S/off 10/7 0206 with vocal 0 Canada. S/on 0755 (JAM)

KWWL IA Waterloo, is 24 hours, SP is MM 0100-0700 (GBS)

1320 KVMC TX Colorado City, fair o/KXYZ 0755 SM 10/13 (GBS)

WKPQ PA Pittsburgh, 10/4 0239, finally logged for call change, in good w/spot (RSK) (I thought they were WKTQ, Rob. Hope they're not

NOVEMBER 2, 1974

WHOK	OH	Lancaster, 10/11 0600, in good w/SSB then s/on (RSK)			
WVOJ	FL	Jacksonville, 10/14 0319, C&W Mx, jingle, fair, better earlier in evening (around 0100) with talk on Florida agriculture (JDF)	CFEK	BC	Fernie, fair w/s/off 0207 10/10. // to CKEK-570 (JAM)
1310	WDXI	TN Jackson, 1901-19 10/12, C&W Mx, promo for Eddy Arnold Show and WDXI Mx, spot for Big Star store and ID as "WDXI, where X marks the spot for Mx," WDOO QRM (GEP) In good w/local spots, 0812 10/8	1230	KSST	TX Sulphur Springs, fairly good o/QRM w/Wx and school lunch menu, 0555 Mx 10/14 (GBS)
KFSB	MO**	Joplin, TT 0105-35 10/7, //(RSK) o/CFGM, IDs at 0105, 0128 (GEP)	WCWA	OH	Toledo, 9/30 0541, good but fady w/R&R Mx (RSK)
CGFM	ONT	Richmond Hill, 0102-31 10/7, C&W Mx, Bill Anderson (?) show, PSA's and cash jackpot promo, heavy QRM from KFSB and CKOY, lotsa QSB (GEP)	WSAL	IN	Logansport, very clear o/QRM w/Wx 0156 10/12 (GBS)
WTLB	NY	Utica, mostly o/UnID MoR (WNIC?) w/C&W(?), fairly clear ID, 0510 9/17 (GBS)	WBOW	IN	Terre Haute, 10/10 0400, in good w/ID (RSK)
1300	WRBC	MS Jackson, here most of MM with R&R Mx and ads, fair w/UnID QRM, 0115 10/14 (JDF)	CJNL	BC	Merritt, exlnt at s/off 10/7 0306. CJNL, CHNL owned and operated by "NL B'casters"(JAM)
WBLG	KY	Lexington, 10/6 0606, poor under WTAQ and WOOD, wx for the home-town, ads, then religious pmn	1220	WCPH	TN Etowah, 9/27 0650, in good w/Local spot (RSK)
KVOR	CO	Colorado Springs, is //(JDF) off MMs 0200-0700, not sure about other nites (GBS)	1190	KAYQ	MO Kansas City, local Mx and talk of K.C. court system, u/WOJO and WPUP. Better after WPUP s/off. Fair-poor, 1927 10/11 (JDF)
1290	KCUB	AZ Tucson, fair u/KCII w/K-Cub ID, Mx, C&W, 0257 Mx 10/14 (GBS)	WUPF	MS	Bay Saint Louis, 10/11 1920-30, Miss. state wx, gulf conditions, tide reports, ID as Total Radio and jingle, 1930 s/off and SSB. WOJO and KAYQ QRM (JDF)
1280	WNAE	WI Neenah-Menasha, 10/11 0414, in briefly w/ID (RSK)	1170	UnID	?? Hrd w/R&R Mx, 0641 9/30, then wx report, way u/KVCO and WWA, any ideas? (JDF)
CJMS	PA	Montreal, FF talk show 0204, poor o/QRM 10/14 (JDF)	KVOO	OK	Tulsa, Mx 10/14, ran OC as late as 0541 (GH)
WONW	OH	Defiance, 10/9 0600, good with end portion of s/on (RSK)	1150	WGOW	TN Chattanooga, 10/14 0438, in fair w/ID, wraps up C'nooga (RSK)
WUTC	IN	Minneapolis, off AN now for several months, new sked is 0600-0200, (0100 Mx), but freq. ruined by NSP KTLK and WGSO (GBS) (I don't even know who WGSO is, George. Wanna trade for CHAMPed.)	KWKY	IA	Des Moines, now on till 0400 some nites with "progressive country" (GBS)
WIXI	KY	Lancaster, 10/4 0706, in poor with s/on (RSK)	1140**	KLPR**	OK** Oklahoma City, 10/14 0114, good, "now concluding equipment check, we will be on the air periodically as night progresses" (GRB)
KTLK	CO	Denver, w/R&R Mx and DJ talk, fair o/QRM, 0334 10/14 (JDF)	EPWB	MO	Piedmont, 9/28 2004, fair over WRVA w/ads, jingle, pop R&R and C&W (JDF)
1270	WRJC	WI Mauston, 10/3 0659, poor with SSB then s/on (RSK)	1120	WWOL	NY Buffalo, 10/10 0630, in fair u/KMOX w/spot (RSK)
WLIK	TN	Newport, 10/7 0609, fair with temp. check (RSK)	1100**	WHLI**	NY** Hempstead, 10/7 0230, in exlnt on ET, OC then ID (RSK)
KTFI	ID	Twin Falls, appeared over WXYZ 0159 10/7 w/Bicentennial Comm. PSA, ID, and NBC Mx, u/KFJZ 0201. New state for me, too bad it couldn't stay in longer(GEP) Briefly on top (just barely)with call letters, then nothing more positively IDable, 0210 9/17(GBS)	1090	WFWR	IN Fort Wayne, 1900 10/11, s/off w/inv. to turn to 102 PM WOCX, no SSB, o/KAAY and mess (JDF)
CHWK	BC	Chilliwack, good over CHAT 10/8 2300, ID as "Fraser Valley Radio," // to CKGO-1490, Hope, BC (JAM)	1070	WCIR	WV Beckley, 0706 10/12, Mx, ads, R&R Mx o/QRM, fair to poor(JDF)
CHAT	ALT	Medicine Hat, good days, poor nites with CHWK, KIRL, s/off 10/7 0303, s/on 0745 (JAM)	1060	WOIO	OH Canton, 0734 10/12, Mx, ads, end of Mx, good o/KYW, WJLJ (JDF)
1260	WDR	IN Indianapolis, 10/4 0244, logged on call change finally w/R&R Mx, exlnt signal (RSK)	WJLJ	MS	Tupelo, 10/12 0715, C&W Mx, ads, wx report, o/KYW, good (JDF)
1250	KFSU	WA Pullman, good w/s/off 10/8 0217, said return at 0630 local (0930)	1050	WADC	WV Parkersburg, per verie, recently changed calls from WGEF (GRB)
WNTS	TN	Tazewell, 10/12 0602, //(JAM) in fair at s/on, some WEDC slop	WZIP	OH	Cincinnati, s/on w/SSB, fairly good o/UnID QRM, 0603 9/27(GBS)
CHSR	MAI	Steinbach, good over //(RSK) CKOM, KWCU 10/9 0200, with Mx, then "Classics Till Dawn," rare here (JAM)	970	WJY	MT Ishpeming, 10/12 0819, Mx and ads u/AVE. MIA s/on 0900, so clear of them. New (JDF)
1240	????	?? UnID, 10/7 0240 w/end of Mx, // to CJIC-1050, gave temp. as so many degrees "at CJIC." Who's // to CJIC ? (PB)	960	KGWA	OK Enid, s/off must be heard to be believed, 0005 nightly (GH)
KBY*	MT	Billings, BT annctm. 0228 10/14, I'm not certain whether a TT hrd at same time was from the same station (GH)	WWST	OH	Wooster, 10/1 0601, in fair with SSB then s/on, much QRM (RSK)
KBIZ	IA**	Ottumwa, 10/11 0233-45, in fair with unsked f/c-TT, WBDC a big problem (RSK)	WRFC	GA	Athens, 10/2 0405, in briefly in WERC null w/Mx (RSK)
			CFAC	ALT	Calgary, 10/7 0250-0301, exlnt w/sports, C&W, ID and Mx on hour (PB)
			950	WAGG	TN Franklin, 10/9 0718, fair with local spot, WJPC on late for some reason (RSK)
			WRMA	AL	Montgomery, R&R Mx and ads, 0410, fair o/QRM, 1974 Vane Jones says they are daytime only. Have they gone MSP? (JDF) (I don't know why this stn is called a day-timer. Per NRC log, they are on 1200-0000 except Fri., Sat., Sun. when they are on till 0500. I also don't know why you can't tell us what day you heard 'em-Ed)
			940	KIXZ	TX Amarillo, R&R Mx and Mx, w/CBM, poor-fair, 2015 10/13 (JDF)
			WMTX	IL	Mount Vernon, 1900 Mutual Mx, and Mx, 1930 s/off, fair, better after WPAW s/off(JDF)(Date 9-11)

930 KSDN SD Aberdeen, 10/15 0156, much wanted, in fair w/ID, sent taped report. They are now AN, per call to station (RSK)

WKY OK Oklahoma City, R&R Mx and talk of Hit Lines open, 10/14 0120, heard all evening, fair (JDF)

WITNNC**Washington, 10/2 0546-49, noted w/unsked f/c, fair-good (RSK)

920 WMNI OH Columbus, 9/29 0557, C&W Mx, ads and promos, u/WOKY QRM, good

WGST GA Atlanta, 10/14 0412, (JDF) MoR Mx and promo for Atlanta Flames hockey, fair o/CKCY (JDF)

KARN AR Little Rock, 10/14 0211, R&R Mx and ads, fair w/CKCY and u/WOKY OC, not regular here (JDF)

910 KRRV TX Sherman, w/soul Mx and ID, good to poor, 0256 10/14 (JDF)

KCJB ND Minot, fair 10/7 0306-11, o/u WSBA w/G&W, ID as "CJB" (PB)

UnID ?? Hrd 10/13 2000 w/Ai Nx, then R&R at 2005, any ideas? (JDF)

900 CKVD PQ Val D'Or, w/FF talk and light Mx 2006 10/12, fair w/CHML, my 500th station (JDF)

KHOZAR**Harrison, 10/6 0643-55, in good w/unsked f/c (RSK)

WATV AL Birmingham, 0701-06 10/1, exlnt w/GBS Nx, Wx, ID, MoR Mx (PB)

870 WWL LA New Orleans, ID as "Radio Interstate 87" (not to be confused with the hiway from New York to the Canadian border), for truckers Wx for WY, CO and NM, 0319 10/14 (GH) (Did you just put that in to see if I'd throw it out, Glenn?-JCK)

810 WSJC MS Magee, local quality 2032-47 10/13 w/Sandy May show, R&R Mx and dedications, Wx, spot for TV, u/R. Sutatenza 2047 (GEP)

800**KDDD**TX**Dumas, 10/14 0206, blasting in on DX w/ID (RSK) On DX test for NNRC, 10/14 0159 OC, ID with address, Strangers in the Night (host Richard Hamilton must have been watching Sinatra special), o/u CKLW w/3 Hz SAH, various easily identified musical selections, IDs and address including zip code 79029 as "area code," at every break; 0224 mentioned one call from Northridge CA, wondered about Alaskan reception, apparently off 0230(GH) On DX test 0200 10/14, fair to good until 0215 when CKLW overpowered the 250 watter (GRB)

WVAL MN Sauk Rapids, 10/8 0730, in fair with swap shop promo (RSK)

790 WAC TN Memphis, fair, constant signal 2004-20 10/13 w/C&W Mx, spots, window sticker contest promo, WBBM slop, only 2 fades (GEP)

KGHL MT Billings, quite a surprise w/R&R Mx and ID, good and alone, 0756 10/12 (JDF)

780 UnID ?? Somebody 10/11 1945-2000 u/WBBM w/C&W or R&R Mx, 5 pips on hour, then what sounded like Nx, not a Cuban, language was EE. Maybe KCRL? One of the songs played was by John Denver (PB)

730 WMNA VA Gretna, 10/8 0700, fair thru mess w/ID for AM and FM, Mutual Nx (PB)

WPAL SC Charleston, 9/28 0622, in good w/s/on, no SSB (RSK)

CKLG BC Vancouver, strong w/R&R o/u XEX 0232 MHz 10/7, not too common since XEX went NSP, CKDM off (GBS)

710 WTPR TN Paris, 0727 10/12, w/many local ads and Nx 0730, u/WLW and WGN slop, fair (JDF)

CKVM PQ Villa Marie, 10/12 2012 w/FF talk o/WHB, good (JDF)

680 WCTT KY Corbin, 2126 10/12, R&R Mx and Wx report, o/CPTR and WRKO, fair, a regular now (JDF)

610 KFRC CA San Francisco, ID and R&R, barely hrd way u/WDAF, 0447 10/7 (GBS)

600 WREC TN Memphis, 10/12 2157, w/Tennessee-LSU game, o/WMT and Cuban (JDF)

WTAC MI Flint, think this was the one u/WMT w/R&R and ads, 1343 10/6, poor, a regular (JDF)

KCLS AZ Flagstaff, 10/7 0200, in good w/ID then KCLS Nx, finally got a report and tape (RSK)

580 CKY MAN Winnipeg, 10/5 0322, in good w/R&R Mx (RSK)

KFXD ID Nampa, sort of a pest here, hrd w/ID, TC, R&R, "It's 3 o'clock at K-F-X-D" 0500 10/2, o/u UnID SSB (WCHS?), also strong MM 10/7 0430 w/no readable QRM. SP:Tues. Best bet for ID (GBS)

560 KLVI TX Beaumont, 10/14 0340-400, fair-good, sometimes under WIND OC and o/WHBQ, w/R&R and K-56 IDs.

550 CHNO ONT Sudbury, was in English when I was thru here last year, 900 kc Sudbury is now FF (JAM)

KARI WA Blaine, fair after KFYR s/off 0200 10/7, EL Mx, then amncr ment. a religious program on hour. No QRM at all (JAM)

540 KNOE LA Monroe, 10/6 2123, poor w/R&R and garbled ID, XEWA/CBEF QRM (JDF)

+++++ Well, as the season goes on, it appears that a great number of reports are coming in, but it seems that quantity has been obtained with a sacrifice in quality. So to you guys who leave out dates, spell towns wrong or even put in the wrong town, report 10 times as much detail as could ever be of help to anyone and/or report UnIDs without enough detail to ever make a decent guess at, may the Great Pumpkin fall on your car the next time you wash it. I mean it, guys. Give a little thought to what you report, and you'll save the editor and yourself a lot of trouble. Well, by this issue, Carol should have her column underway, so hi and welcome, Carol. If you have any problems like I do, well, remember there's always at least one sympathizer. I got one of those one-page DXMs today with Glenn Hauser's Forum report in it. It looks as though if you send a reception report to KGYN with "reception report" written all over it, the secretary will hand it over to the CE who consigns it to oblivion in his desk. If you write "gas bill" or somesuch, maybe she will open it and verify it for you. If I ever hear KGYN I don't think I'll bother to report to them. But I believe this is at least a representative of many nonverifying stations. Since no one has any real interest in verifying, the people there refuse to take the time to set up a very simple system by which reports could be verified with a minimum of effort. It is too bad that there are apparently some people who believe that DXers get their kicks from throwing letters in mailboxes, and never consider they are the slightest bit offensive when they allow letters to pile up in drawers for years. When the letters are finally extracted, there is such a pile of them that they will be tossed in the wastebasket for the slightest of reasons. Well, its pretty late, so I am telling my typewriter goodnight and 73--Charley - - -

western
dx roundup

Station skeds and tests etc. Deadlines are Thursdays

610 KAVL CA Lancaster sked seems to be 0756(1056)-0210. RS is uptempo MoR & light rock & is mostly automated. (BP-CA)

640 KFI CA Los Angeles has SP MM's 0600-0700 or thereabouts. Appears to be every week, as noted off every MM I've checked. (BP-CA)

800**KDDD**TX***Dumas 10/14 0200-0203. S/on for club test w/ "kay triple D, Dumas, TX" ID and into recording of "Strangers In The Night". Poor to fair w/ PJB & heavy splash from local KCEE. (RJS-AZ)

900**WMOP**FL***Ocala 10/20 0126-0128, portions of record of "Killing Me Softly", then full ID very faintly at 0128. Poor w/heavy fading. XEW carrier may still have been on. This was NRC test. (RJS)

940**KGRL**OR***Bend finishing f/c-tt 0330 10/7. (BP-CA)

1230**KQIK**OR***Lakeview good o/u QRM on r/c 0308 10/7 w/code ID's every minute. (BP-CA)

KOZIWA***Chelan good on f/c 0328 10/7 w/several code ID's in a row. (BP-CA)

1280 KVOV NV Henderson s/off after SS pgm 2200 10/4 which is an hour after they're supposed to s/off, per LSR/LSS map. (BP-CA)

1360**KRUX**AZ***Glendale 0635-0643 testing. No QRM. Strong as KOOL-960. (JL)

1390**KHOB**NM***Hobbs loud on ET-rr 0700 9/30. (BP-CA)

1450**KVSL**AZ***Show Low good on r/c 0332 10/7. (BP-CA)

+0338-0345 testing. Unid QRM in background. QSL letter in 8 days. (JL-CA)

KOPO AZ Tucson, correct MM SP to 0300-0800 (not 0300-0500). (RJS-AZ)

1490**KDBM**MT***Dillon super strong on r/c w/voice & code ID's 0305 10/7. (BP-CA)

KCUZAZ***Clifton loud on r/c w/ID 0323 10/7. (BP-CA)

1540 KBES WA Bellvue now 24 hours NSP. (JFO-WA)

1590 KUUU WA Seattle s/on on weekdays, SM, and MM at 0300 w/o SSB. This was formerly an NSP pest. First discovered off at 0300 10/14. The greatest thing to happen in Seattle since the 1889 Great Seattle Fire! (JFO-WA)

"Normal"DX

590 KUGN OR Eugene 10/16 0510 w/ID, TC, pop mx, spot for Senior Citizen Day. 75% readability w/fair reception. (RB-CA)

KHQ WA Spokane 10/18 0800 w/state nx, smog alert for Spokane, wx for Expo City, ID. 100% readability w/xint reception. (RB-CA)

620 CKCK SK Regina fair w/cw u/KTAR 0416 10/7. (BP-CA)

650 KORL HI Honolulu 10/18 0623 w/ID, TC. 100% readability Faded out after 2 minutes. The slop from KFI was too much. (RB-CA)

730 KBOY OR Medford s/on 0900 10/1. (BP-CA)

CKLG BC Vancouver 10/19 0820 w/rr, ID. Very poor reception w/40% readability. (RB-CA)

770 KXA WA Seattle s/on 0902 9/11 no anthem o/u KOB/JOUB.

790 KULF TX Houston w/wx u/KABC 0653 9/30. (BP) (BP)

800 CKOK BC Penticton s/off w/Lord's Prayer 0317 10/7, to return at 0900. (BP-CA)

900 CHML ONT Hamilton apparently the one w/soft MoR & many ads for Hamilton w/GJVI nulled 0132 9/29.(BP)

920 KVEC CA San Luis Obispo 10/14 0259-0300. S/off followed by SSB. Only fair, mostly u/KORK + others. New here. (RJS-AZ)

KARN AR Little Rock fair w/nx & MoR 0605 9/30. (BP-CA)

930 KAFF AZ Flagstaff s/off 2127 9/30 w/woman singing ancient c/w song, ID'ing as "Calf" & mentioning the "City of 7 Wonders", good w/KHJ nulled.(BP)

KHJ CA Los Angeles 1934 10/7. Faint u/KSEI w/man talking. Positive ID at 0000 10/8. (JFO-WA)

KIUP CO Durango fair u/KHJ w/Intermountain Network news 0907 9/30. (BP-CA)

KSEI ID Pocatello poor w/NBC news way u/KHJ,WKY 2305 9/28. (BP-CA)

950 KMER WY Kemmerer s/off 2130 9/27 w/"Have A Happy Day" jingle. Poor w/mucho QRM from XEGM, KIMN & unID c/w.(probably KAHJ-JAB). (BP-CA)

970 KVEG NV Lost Wages s/on poor in mess 0900 10/3. (BP)

KOIN OR Portland o/u QRM w/"Spectrum" promo & MoR 0728 9/12. (BP-CA)

980 KEAP CA Fresno good w/cw o/u KFVB 0921 10/3. (BP-CA)

KUPI ID Idaho Falls fair-poor u/KFVB w/nx 0855 9/30.(BP)

1060 KUPD AZ Tempe 10/21 0520 w/MM pgm, ID, nx, wx, rr. Good reception w/100% readability. (RB-CA)

1110 KCIA NM Humble City s/on SSB 0800 9/16 into c/w. (BP-CA)

1150 KBAI CA Worro Bay strong & atop all w/apparent s/on, "K-BAY" ID, & MoR 0905 10/7. (BP-CA)

NOVEMBER 2, 1974

WJBO LA Baton Rouge 10/15 0559-0605. S/on fair to good, w/KIIS. Mentioned affiliation w/NBC & into network news. Louisiana nx at 0605. No anthem heard. (RJS-AZ)

KKEY OR Portland good w/automated c/w to 2230 s/off 9/29. (BP-CA)

KAYO WA Seattle 10/21 0645 w/ID, cw mx, TC, spot for 10/26 cw show w/Rick Kenney at the "Space Needle". Fair w/60% readability. (RB-CA)

1210 KWBC WA Seattle. Ex- WFUN pirate station on 1573 has changed calls and frequency. Carrier current station heard w/requests, "Bad, Bad Leroy Brown", and ameturish DJ at 1750. DJ's name was given as Gary Mathews. (JFO-WA)

1220 WGAR OH Cleveland fair w/rr 0610 w/QRM from nulled CKDA & unid SS. (BP-CA)

KRMC OK Oklahoma City 10/16 0705-0708, failed to get their s/on, but heard their Oklahoma nx, followed by good call. Fair w/XEB. (RJS-AZ)

1230 KCBN NV Reno 10/21 0624 bombing over the graveyard mess w/KCBN nx. Great reception. Rock mx. (BMS-CA)

1250 KHIL AZ Wilcox s/off 2100 9/26 w/cw guitar mx. (BP-CA)

KPAC TX Port Arthur 10/19 0558-0600. S/on from daily SP w/ID, then SSB, then usual s/on info (RJS)

1260 KTEE ID Idaho Falls s/on strong way o/KYA 0800 9/17 into Ai nx. (BP-CA)

1280 KMAS WA Shelton 2022 10/14. Much wanted finally heard w/religion program and "Thank you for listening to KMAS Shelton", then into 7030 s/off. (JFO-WA)

1290 KSNN ID Pocatello s/on 0803 9/11 into rr, strong. (BP)

1310 KARY WA Prosser s/on amidst mudheap 0900 9/16. (BP-CA)

1320 KCRA CA Sacramento "This is KCRA, Sacramento" momentarily surfaced o/KCPX 0400 10/13. Not enough for a report. (JFO-WA)

1340 KDOL CA Mojave s/off in middle of "America" 0158 9/29. C/W format. (BP-CA)

1350 KDOV OR Ashland s/on 0901 9/16. (BP-CA)

1380 KPOI HI Honolulu 10/21 0433-0436. "Kay-poi" twice at 0433. After record, another "Kay-poi" and a "K-P-O-I" call. Exceptionally strong & well on top of channel. Must be the best reception of any Hawaiian ever here. (RJS-AZ)

KOTA SD Rapid City poor w/cw 0715 9/17. (BP-CA)

1390 KENN NM Farmington noted about 0750 10/21 w/Navajo chants. Fair signal. (BMS-CA)

1410 KKOK CA Lompoc good w/rr & promo for their morning man 0910 10/1. Catch #500 after 2 months of DXing. (BP-CA)

KLSC OR Portland fair-poor w/ancient rr songs u/KERN 2227 9/28. (BP-CA)

1470 KOLI CA Coalinga fair u/XEBBC w/rr, ID as "Koly", & SSB s/off 2130 10/7. Local KUTY off around 2040 this day for some odd reason. (BP-CA)

KRBC TX Abeline s/on 0600 10/3 atop frequency. (BP)

1490 KTOB CA Petaluma ending farm news 0900 9/13. (BP-CA)

1520 KAMX NM Albuquerque s/on SSB into SS pgm u/KOMA 0801 9/30. (BP-CA)

1540 KBES WA Bellevue AN w/soft MoR 9/23, 9/30, 10/7 MM's so now maybe NSP. (BP-CA)

1550 KGAR WA Vancouver s/off u/KKHI/XEBG 2230 9/28, mentioned owned by Mr. Gordon A. Rogers. (BP-CA)

CBE ONT Windsor s/on O Canada 0458 9/30. (BP-CA)

1560 WTAI FL Melbourne 10/21 0700 w/s/on followed by C&W. Real surprise for my first Floridian. (BMS-CA)

1590 KTIIL OR Tillamook 0309 10/18. With s/off "The Federal Communications Commission operates KTIIL, broadcasting on a frequency of 1590 kilohertz." Surfaced over KLIV. (JFO-WA)

This time we heard from:

(RB) Richard Bessette- 706 Polk Street- San Francisco, CA 94109 (DX-150-B)

(JL) Joseph Lieberz- Box 9130- Glendale, CA 91206 (equipment??)

(JFO) Jon Orren- 5004 17th Avenue Northeast- Seattle, WA (Hallcrafters S-120 and 3' spiral loop)

(BP) Bruce Potzit- 767 West Kettering- Lancaster, CA 93534 (SPR-4 w/SM-2 or phone lines, Sanyo portable)

(BMS) Brian M. Scully- 1301 Wardman Drive- Brea, CA 92621 (DX-150A w/40' LW)

(RJS) Bob Small- Box 4548- Tucson, AZ 85717 (SPR-4 w/ Sanserino loop)

WGL

FORT WAYNE INDIANA'S
FIRST BROADCASTING STATION
"Broadcasting Since 1924"

1000 W—1250 KC—CBS NETWORK

PERSONALITY & PROGRAM PROFILE

Al Wayne Show



Otherwise known as Al Ogrizovich

TYPE: Evening Record Program, plus News-Sports-Weather

TIME: Monday through Saturday, 6:00 PM to 12:35 AM

Al Wayne, now established as the "Night Life" sound of the Good Life, came to WGL as an already accomplished announcer with a long list of radio credits. Al is a graduate of Whiting High School in Whiting, Indiana. He started as an announcer when he was just 17. That fact, coupled with his education at Elkins and DeVry Institutes in Chicago, where he received his First Class FCC License, accounts for the smooth flow of good music six nights a week that entertains the WGL audience.

In addition to his announcer ability, at some of the other stations he has worked, Al has served as News Director, Public Service Director, Chief Engineer, and on a vacation basis, even as General Manager for a few weeks.

Al is only 20 years old, but he possesses a taste for "The Good Life" in his music selection.

WGL RADIO COVERS FORT WAYNE'S 15-COUNTY TRADING AREA

The Little Show Of Kindness

QSL For Reception at
Gilmanton, N.H.
August 20, 1974

Awarded By

TO:

Mr. Peter W. Kemp

13-B Fleetwood Avenue

Bethel, Conn. 06801

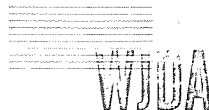

479 1300 ON YOUR DIAL
Quincy, Massachusetts

This 28th day of August 19 74

THE WASHINGTON SCENE

by John H. Midlen, Sr.



Use of Broadcast Facilities by Political Candidates. The Commission has released a Public Notice designed to afford guidance to broadcast licensees with respect to the limitations which may be imposed on the right of political candidates to use broadcast facilities. Specifically, the Commission made clear a licensee may not deny access to prime time by candidates for federal office nor arbitrarily deny candidates for any public office the right to purchase the various lengths and/or types of spot announcement which are available to commercial advertisers. Although licensee discretion is not foreclosed, the Commission states that it would be unreasonable for a licensee to adopt a rigid policy of refusing to sell prime time programming to legally qualified candidates for federal elective office. Prime time as used by the Commission means evening hours for television and drive time for radio.

Posting of Operator Licenses. The Commission has revised its Rules to eliminate the posting of operator licenses in AM, FM and television broadcast stations. It is now permissible to put the license in a binder or in a folder and retain it at the control point. Licensees are no longer required to have the licenses posted on the wall at the control point. Additionally, the Commission clarified its rule to require that operator's licenses must be available at the control point during both on-duty and off-duty hours so long as the operator is in the employ of the station, either full-time, part-time or on a contract basis.

Application of the Fairness Doctrine. The Commission has issued a report which concluded an inquiry it began in 1971 on the effectiveness of the Fairness Doctrine. The Commission reiterated the basic two-fold duty of the Fairness Doctrine is that broadcasters must devote a reasonable percentage of time to the coverage of public issues and coverage of these issues must be fair in the sense that it provides an opportunity for presentation of contrasting viewpoints. The Commission will continue to rely heavily on reasonable and good faith judgments of licensees in determining what constitutes a controversial issue and how to insure both sides are presented. The doctrine will not, however, be applied to standard product commercials except where paid announcements are obviously and meaningfully devoted to the discussion of public issues. However, false and misleading advertising should not be accepted by licensees. The Commission also stated that it will continue to consider all fairness complaints at any time, but charges of news misrepresentation will not be investigated unless substantial extrinsic evidence is presented which on its face reflects deliberate distortion.

Newspaper-Broadcast Station Cross-Ownership. The Commission heard two and a half days of oral argument on the question of whether it should require the breakup of commonly owned newspapers and broadcast properties in the same market. The Department of Justice, which originally proposed the rule, argued that on economic and antitrust theory no one entity should be allowed such combinations. Broadcasters and newspapers generally argued no evidence had been presented to show abuses which would justify divestiture of such combinations. The Commission hopes to make a decision in this matter this fall.

Aug.-Sept. 1974—Religious Broadcasting—



KWET
P. O. BOX 420
WICHITA FALLS TEXAS, 76307

88
kxok 630
7777 BONHOMME AVE. • ST. LOUIS, MO. 63105

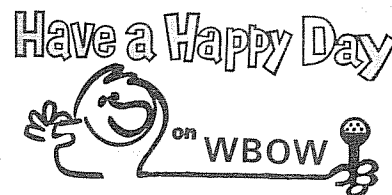

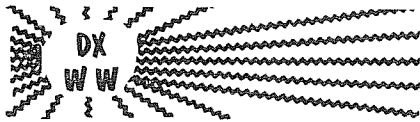

Ron Schatz § Box 592814 AMF § Miami, FL 33159
AC305-945-4915 § Deadlines: Wednesdays
Airmail your MM DX; see it here in just 10 days!!

If you haven't guessed by now, last week's issue of DXWW was the annual Hollowe'en edition. Note, how words taken casually in live conversation become shocking when printed! § As noted above, our new Wednesday deadline is ideal for Monday-AM DX reports. Airmail it first thing MM, I'll get it on Wednesday, & you should see it in print in 10 or 11 days. This I believe is the fastest service available. § Bob Foxworth suggests the inclusion of DX "condition" summaries in DXWW, in the order of "DX has been so-so w/openings to so-so," etc. Personally, I like the idea, but since I'm time-pressed I can't guarantee printing them if they arrive as late as Tuesday or Wednesday. One rule, tho: KISS - keep it short & simple. One long sentence of 2 or 3 clauses is recommended, especially where the potential exists for my handling up to 15 such DX CX reports per issue. § Would like a survey preference for an abbreviation for "male & female announcer". I've been using M&W, M&F, OM/YL, etc. Preferred abbreviations for "announcer", "instrumental music", "mention" & its forms, "QRN" or "noise" or both, etc. Let me know.

Corrections to CuBaMaiTien List

- 560 CMKN R. Rebelde 1000 Santiago de Cuba (new)
- 640 CMDW R. Liberación 1000 Guantánamo (x-1130)
- 820 CMCA R. Metropolitana 10000 Habana (x-CMCA)
- 1320 CMKQ R. Canoa 250 San Luis (new) /-te)
- 1400 CMJI R. Florida 250 Florida (x-Cad. Agramont)
- 1475 4VAA LV du Peuple 750 P-au-P (x- 250 w)

Reprinting of above list in IDXD permitted & encouraged (RFS)

DXWW repertory players:

- John BRADLEY; Colorado Springs, CO (Astronaut 8)
- David BALL; Downsview, Ont. (DX-150A, LW)
- Richard ECKMAN; Phila., PA (Grundig, "Satellit")
- Eric FADER; Bayside, NYC (Candle TK-1848, CTR-18C)
- Robert FOXWORTH; Mineola, LI, NY (HQ-15C, loop)
- Stephen FRANCIS; Alcoa, TN (Realistic TRF)
- Larry GODWIN; Corvallis, OR (??)
- Charley KELEHER; Fort Wayne, IN (XCR-30)
- Ralph KEMPER; Grand Junction, CO (Norelco portable)
- Albert LOBEL; El Cajón, CA (DX-150A, Sanserino loop)
- Richard MAYHEW; Valleyfield, PQ (DX-150B, 4 LW's)
- Bruce SHAW; Ligonier, PA (DX-150A, Mosley SWL-7)
- C.M. STANBURY; Crystal Beach, Ont (HQ-200, RAX-1)
- David WILLIAMS; Astoria, OR (SPR-4, 75S-3C, SM-1)
- Ron SCHATZ; Uleta, FL (R-388/URR, LSCA, TFM-1600)

DX Conditions § Period Ending 21 October

"Conditions TA-wise have been pretty poor lately" (Eckman)

"Sat eve 10/12, TA opening started 2300z. In addition to many midband TA freqs, CBI-1140, CBD-1110 & St. Pierre-1375 were all in well. Cooled off a lot by 0200z 10/13. Agadir-935 was still in at 0200 but lots weaker than earlier. By 0300 10/13 cx had turned to auroral, w/flutter on 1080, 1140 domestic, etc. By 0500 10/13 cx were blah, noisy & TA's were gone" (Foxworth)

"Conditions for period were fair, w/static present but minimal. Low-band TA's present most nights w/fair signals, high-banders all but absent. Excellent DSA opening in mid-October w/Paraguay-645 good. Multi-skip cx poor end of period." (Schatz)

Trans-Pacific DX Roundup

- 660^t AUSTRALIA, Byrock, NSW, 2BY probably the ABC stn // 2NR-700 at s/off 10/2 at 14C1 w/anthem. Also heard // 2NR 1500 10/17 w/6 pips, then ABC news. Very weak both times (Godwin)
- 665[?] UnID as reported by Dave Williams heard fairly strong 10/8 1330-1400. Appeared undermodulated; i.e., strong carrier but weak audio. Lgg

NOVEMBER 2, 1974

- 700^c seemed sing-songy; perhaps China? Not regular like 655 is, so I doubt N. Korea (Godwin)
- AUSTRALIA, Grafton, NSW, 2NR heard virtually every AM, & is probably the easiest DU from here. ID at 1355 9/30 was only "You're listening to the ABC Radio 3". At s/off 1400, ancr said s/on would be 0500 LT (Godwin)
- 720[?] AUSTRALIA, I think, heard 10/15 & 10/17 1330-1430 off & on. Signal was weak at 1400 both AM's, but if there had been pips, I think I'd have heard them (Thus unlikely it is ABC). On 10/15 had C&W pgm 1335-1400, mentioned "country music time" at 1335. At 1348 mentioned "Australia" & "New South Wales". On 10/17 noted Simon & Garfunkle at 1413. Who? (Godwin) § UnID heard 10/18 1306-1425 w/jazz pgm & Glenn Miller type sounds. At 1400 mx ended & ancr said "You're listening to ..." followed by 5 pips, same pitch as ABC pips. Then more jazz (no other anmts). I thought all ABC stns had 6 pips as IS. I'm not ruling out 6WF here (Godwin) Maybe either you or the stn lost count?? (RFS)
- 830^c HAWAII, Honolulu, KIKI, rock mx 10/15, OM anmt 1322+ w/TC for 0323 AM Tuesday. Good solid signal, no sign of Japan, 0329 TC at 1329+ & ID (Williams)
- ...^t JAPAN, Oseka, JOBB surely must be the strong Oriental here // several other freqs (870, 770, 700) heard most AM's around 1400. On 10/2 there were 4 pips (3 low, 1 high). As I remember, this is the characteristic IS for NHK & also for N. & S. Korea. No mention of NHK on the hour like they used to. I remember from Berkeley I used to hear NHK stns s/off at 1500 giving call-letter ID's, so I'm waiting for those shorter days in November & December! (Godwin)
- 1178^c JAPAN, Okinawa, VOA is so strong here some AM's, it's incredible. Monitored 9/26 & 27 between 1330-1400, by far the best time slot to hear this one, as its antennas favour NA reception (Should be audible as far east as Texas/Kansas for sure). At 1330 ID before favorable antenna change is "You're listening to the Voice of America from Okinawa". Then comes the antenna change, then "This is the Voice of America. The following pgm is in Korean", then Yankee Doodle. At 1400 full ID again before antenna change back toward the Asia mainland. Get it! (Godwin) I did - a few years back, but not well enough to log. Would someone please provide us w/"favorable" antenna times? (RFS)
- 1420 HAWAII, Honolulu, KCCN a surprise at 1000 s/off 9/16, very weak w/KSTN OC w/several ID's. KTOE off, KSTN silent for a few minutes (Kemper)

North-American DX Roundup

Again, this Roundup includes Alaska, Yukon, NWT, Greenland, St. Pierre, & Bermuda BELOW the Arctic Circle.

- 750^c ALASKA, Anchorage, KFQD 10/7 1149-1200 t/out. Pop mx pgm, Beatles selection 1154 ... TC 1157 for 2:57. "Ken Gregory with KFQD News" at 1200 (Williams)

Trans-Atlantic DX Roundup

It's raging controversy time as Foxy submits long-wave items for DXWW:

- 164 FRANCE, Allouis heard w/clear signal around 0500-30 10/2 & same time, even better 10/5 when in past 0640, hitting S8 at peaks. Generally just a weak carrier here so far (Foxworth)
- 180 GERMANY-W. Weak audio from Europa I in GG 0530 10/5, only reception so far this year (Foxworth)
- 209 MAROC, Azilal nice & clear 0530-0630 10/5 apparently AN for Ramadan (Foxworth)
- 584 ESPAÑA, Madrid, RNE clear & S7 to 8 0205 10/13 during TA opening (Foxworth)
- 683^x (NYC) Continuous carrier here & on 737 are audio sidebands of WOR-710's new STL using 27 khz subcarrier on pgm channel for control purposes. WOR's audio can be heard very weakly on it, but smudgy. 737 is a lot clearer, with S7 carrier here at all times, but still weak audio (Foxworth)

- 737^x (NYC). See 683 above (Foxworth)
- 764 SENEGAL, Dakar assumed the one here w/native chanting & brief periods of talk on 10/13 2310-30. Good to excellent level at times but WABC slop was of course troublesome. Occasional deep fades noted around every 5 minutes or so (Eckman)
- 854 ESPAÑA. Good signal at 0045 10/13 mentioning "Radio Nacional" (Foxworth)
- 935 MAROC, Agadir noted 10/12 2315-45 w/typical AA chanting & mx. Up to excellent level & readability at times. Later at 0355 10/13 it was very strong, still w/AA chanting. On AN for Ramadan, I suppose. 818 seemed // to this around 0400 but at only fair level (Eckman)
- 989 ESPAÑA. Fair signal on this seldom-heard channel 0050 10/13 during TA opening (Foxworth)
- 1097^t CANARIAS, tent. the one here w/YL in SS 2320 10/12, slow ballads, fair signal. Recheck at 0001 showed carrier still there but I've must've missed s/off, if any (Foxworth)
- 1196 MAROC, Agadir presumed the one here S6 & clear (except for ITV) w/West African "stick-beating" mx 2315-2400 10/12. Just popped off at 0000. (Foxworth) This is the Berber service. The mx sounds more Tropical African than Arabic.
- 1502 ESPAÑA, Sevilla, Radio Popular de Sevilla, C.U.P.E. ID'ed here at s/on 0501 9/23, also mentioned 99.6 FM, this apparently is the dominant COPE here. Heard fairly well several times (Foxworth)

Trans-Arctic DX Roundup

This Roundup includes all receptions whose signals traverse the Arctic Circle:

- 1525^t CHINA, Urumchi. Weak, fluttery female voice, just barely ID'able, w/another carrier about 10 Hz apart, exactly on 1525 heard 0010 9/16 in disturbed cx, soon faded. Maybe China w/a "doughnut hole" reception? (Foxworth)

Pan-American DX Roundup

Just my luck to lose notes on some good DX.

- UnID HC noted w/native rhythms on 1235 khz. UnID LA also on 1246 khz, not Haiti. Mystery on 728 khz tentatively "Titania" in Chinandega, Nicaragua. A "mystery" that cost me 2 hours sleep on 776 khz turned out to be a mixing product de WFUN-790 & CMJN-783!! One thing I don't need is a supersplit! (RFS) Misplaced times & dates on above, so not up to standards, hi (RFS)
- 540 COLOMBIA, Bogotá, R. Horizonte on top of several other LA's w/"Hora de Colombia" 0512 10/14 & SS mx. Had a great signal, completely readable (Fader)
- 550^t VENEZUELA, Caracas, R. Mundial w/tent. ID (not clear 0513 10/14 o/u Cuban. Exc. signal, but the Cuban had a "more exc." signal, that I can do w/out, hi (Fader)
- 580 CUBA, Ciego de Avila/Baracoa noted 0507-10 10/14 w/a good signal, no QRM to speak of, // 590, 600, etc. New (Fader)
- 610 COLOMBIA, Bogotá, Em. Nueva Granada really w/a great signal, bombing in & wiping out semi-local WIP 0410-20 10/14. Long detailed ID 0500, new (Fader)
- 620 VENEZUELA, Cabimas, SS mx 10/14 0520+ of == strength as YNM, both ID's noted at 0529, this one w/a "Radio Libertad" ID. Both new. Only QRM was from WSUN, local pest WVNJ off (Fader)
- ... NICARAGUA, Managua heard 0520-30 10/14 w/SS mx mixing w/Liberatd. Good ID as "Radio (static) Nacional", I think, 0529 right after Libertad (also see above) ID (Fader)
- 625^t COSTA RICA, San José, R. Omega was presumably the weak one here at 0330 10/11 w/CA signals in on 575, 655 & 675. However, as a current Continental Electronics brochure claims that the MW XR used by La Voz de la Victor & Christian Broadcasting Network on this channel is still installed in Central America, it is conceivable that R. Omega could at any time be shifted to one of the higher freqs reported by RFS to be opening up in the 10/5 DXWW, e.g. 1220 khz (Stanbury)
- 640^c CUBA, Habana, 9/21 0531 w/LV de Cuba ID & chimes, fair signals. Reheard for contest (Mayhew)

- 645^s PARAGUAY, Cnel. Oviedo, R. Caaguazú. ZP reported here heard well MM 10/14 0630 t/in to 0706 when quit. Strident man w/notices, seemingly, echo reverb on voice at times. DJ pgm w/lots of mx, flowery guitars & up tempo ballads. Some of that sounded like Andean mx. Fades from occasional S7 on peaks to S3 or less & moderately bad QRN. Heard on both antennas. Mentioned "Buenos días, amigos de Radio Caaguazú" at 0655 in a message to "all men & women", at 0702 a message dealing with transport, w/no discerned "legal ID" on the hour, at 0703 a TC "exactamente 4 horas 11 minutos" but at 0630 said "en Radio Caaguazú la hora exacta 3 horas 33 minutos", was weaker & had splash from CMQ-640 then. I thought I heard Paraguay mentioned then at 0645 but not sure. No other place names picked out, may be due to my lack of familiarity, tho. Mx at 0648 was exceptionally clear, as good as anything noted. Freq. was measured at 644.98 & stable (measurement w/in 10 Hz) (Foxworth)
- 650 COLOMBIA, Bogotá, Ems. Monserrate in very well 10/21 after WSM s/off. ID 0558 which went like this: "Esta es Radio Centro Popular, en Bogotá, les habla Emisoras Monserrate" (Shaw)
- 655^c EL SALVADOR, San Salvador, R. Nacional de El Salvador ID 0230 9/17. T/in 0225 to very poor, weak signal, faded in (a miracle, hi) to fair signal on ID 0230 & faded out to poor again by 0232. Much talk around ID, a little mx before, auroral cx. My new DX-150B allowed this in easy because of its much better selectivity o/my old transistor radio. I assume that YSS will become a regular here on auroral eves from now on. New country (Schatz)
- 660 CUBA, Snata Clara, tent. w/soft mx 0536 10/14 u/WCBS audio on WNBC OC, hi. Prob. relaying CMBQ as // 1060 (Fader)
- ...^c MEXICO, D.F., XERPM very strong w/"Radio Juventud" ID 0228 10/18 (Godwin)
- ... COLOMBIA, Zambrano. 3 Big-Ben style pips 0928 10/14 followed by lengthy s/on & presumed NA 0931. S/on included mentions of Bogotá, Montería & at least one HJ callsign (HJND -RFS), but little else was readable due to WPTF & super subdued ancr. Radio Nacional de Colombia ID cinched it at 0957 (Francis)
- 690^c CUBA, Habana, La Voz de Cuba ID 0627 9/22, fair signals. I did not think they were LVC at night? Reheard for contest (Mayhew)
- ... MEXICO, Tijuana, BC, XETRA 0558-0636 9/23 fair w/usual MoR mx, ID's at 2 minutes after hour & half hour, "X-T-R-A, Extra, AM Stereo, 6-9-oh" this by OM, then SS ID by YL. Per Albert Lobel in CA, this stn is b'casting separate "stereo" channels on 688 & 692 khz. Some voice loggings may be possible thru their mx, as KHEY's s/off anmt at 0559 came thru rather well, tho their SSB inaudible (Keleher) § 9/30 0500-05 poor, heavy noise, end of Mexican National Hour, SS ID, easy mx, heard after KGGF s/off (Bradley)
- 710 VENEZUELA, Caracas. WOR was silent 10/16 & R. Capital very loud here w/US rhythm & blues, many w/EE lyrics, only ID's were jingles, "Oiga Radio Capital" (Foxworth)
- 725 SURINAME, Paramaribo, SRS noted w/fair signals 10/74 0330 s/off in Dutch following pgm of US soul mx (Stanbury)
- 730 COLOMBIA, Bogotá heard in very well 10/14 w/SS mx, "Esta es Radio Melodia". New (Fader)
- 750 COLOMBIA, Medellín, LV de Antioquia heard with elaborate ID & ancmts 0730 10/14. Very powerful, new. At first thought to be YNX, which of course was off (Fader)
- 760 COLOMBIA, Barranquilla, LV de Barranquilla heard 10/14 0725-35 w/typical HJ mx. No co-channel QRM, WABC had talk shows which made slop no pbm (Fader) § La Voz de Barranquilla ID 0030 9/17 w/many mentions of Barranquilla & Colombia. Fair o/QRM mess of weak WJR & other LA. Auroral cx, new str. (Mayhew)
- 770 EL SALVADOR, San Salvador, YSKL good after WABC Fadeout 1112 10/14 w/ID as "R. Emisora la K-L, la poderosa". Frequent spots, lively mx & shouted TC's by DJ Fernando Casanova (Francis)
- 780 BR. VIRGIN IS., ZBVI tent. the one here w/soul mx segued 0012-24 10/13. Channel clear with the Cuban jumped up to 783. No anmts, faded for ID (Foxworth)

834^c BELIZE, R. Belize in fair to poor o/noise & splash w/nx by YL til ID 0203 9/17. Auroral cx. Another one I expect to become a regular on auroral cx since I'm using a better RX. Was only heard 2-3 times before on my old RX.

860^c REP. DOMINICANA, S.D., R. Clarin very strong on auroral cx w/ID 0713 9/22. Reheard for contest (Mayhew)

... MEXICO, Tijuana, BC, XEMO good 0810-37 w/gospel mx, many ID's & spots for Gospel album, all EE w/only brief SS ID's (Keleher)

920[?] UnID 10/14 0325, sounded like nx feature, short speeches in SS, followed by xlations in EE. Speaker sounded mildly hostile to "norteamericanos" tho speeches seemed calm & rational. Just caught end of pgm, mx pgm began 0330 w/SS anmts & trumpet fanfare. Briefly o/all domestics. Cuban or YVQX? (Keleher) Not Cuban. Tape requested (RFS)

930⁺ MONTSERRAT, R. Antilles. In the 9/7 DXWW RFS noted reception of Deutsche Welle pgms from R. Antilles. This interim relay arrangement was reported in the works a couple of years ago but Ron is the first DX'er to report reception of it. Further, the latest DW schedule which does even include the Sines, Portugal relay which they claim to lease but in fact own (as noted in the Oct. PE) has NO listing for 930 khz. What are the times of the RA relay? Languages? What's all the mystery about? (Stanbury) Haven't monitored this in months, so can't tell if still relaying DW. Lgg EE, SS, & FF. What's all the ballyhoo about? (RFS)

940 COLOMBIA, Cali, R. Eco weak but clear Todelar ID u/CBM 0500 10/14, south-enhanced because of auroral cx this AM (Foxworth)

...^c MEXICO, D.F., XEQ ID 0553, good signal till s/off 0600 9/22. No MA played after brief s/off anmt. Reheard for contest (Mayhew) § XEQ on 9/7 u/CBM w/SS tx, LA mx at 0445. Fairly good signal (Ball)

944 HONDURAS, Tegucigalpa, R. Panamericana ID about 0520 & continued to 0600 s/off MM 10/14. Nice signal, S7-8 on peaks. Romantic mx, anmts by YL. ID at 0600 long & detailed, "hache-ere-igriega-dobleu" 3 times, freq as 950 but heard almost exactly on 944 (not 945), off w/no anthem (Foxworth)

990[?] UnID someone s/off 0505 10/14 w/anthem, same as heard on 820 going off at 0455. Was SA, not a YV, & I think HJ. Need help ID'ing the anthem, which I had on tape (Foxworth) Tape requested (RFS)

1000^{hv} COLOMBIA, Armero, "R. Ambalá" (or is it really Umbelá as it sounds to me?). If Hauser is right about the fundamental then it is now on this freq (1000.3 khz). Is providing nightly reception on 3001 khz (Stanbury)

1020^c VENEZUELA, La Asunción, R. Margarita bombing in as usual on auroral cx, ID 0341 9/16. Fast LA mx, some SS DJ talk. QRM from weak KDKA at best. Reheard for contest (Mayhew)

1040^c COLOMBIA, Barranquilla, R. Tropical ID 0353 9/16 then mx, long fade & then a full ID 0403. very strong at times, but had long fades every 4-5 minutes for 2 minutes. Auroral cx, new stn (Mayhew)

1050 MEXICO, Monterrey, NL, XEG heard w/currently popular Soul mx 0740 10/14, tremendous signal, no QRM. ID'ed by mention of 100,000 watts, who else is? Hi (Fader)

1060 CUBA, Habana, R. Enciclopedia tent. w/soft mx 0745-48 10/14. Prob. being relayed by 660 as was // (Fader)

1100^c ANTIGUA, St. Johns, ZDK reheard for contest, bombing in as usual on auroral cx. "Big 11" ID's 0010 9/19 (Mayhew)

....[?] UnID strong LA w/EST/CDT TC & 2 mentions of "R. Parisa" or the like 0700 10/14 (Francis) Nothing here (RFS)

1180 CHILE, Santiago, "R. Portales" heard for the first time w/VOA-Florida still on the air w/"76 Trombones" theme 0306 10/2, then gong IS at 0310. Is rougher going in mid-October w/KOP1 stronger in the eves now (Godwin)

.... BRASIL, Rio, R. Globo thru R. Mil, HIBE who s/off 0552 10/13 & in well after. Globo was actually even w/WHAM on weekday 9/18 at 0600 on long wire. Really a good signal (Foxworth)

1190^t VENEZUELA, Barinas, w/mention of Venezuela, 03 mx & talk 0705-10 10/14. Tentative, this is the only YV listed on at that time. Any YV here would be new (Fader) // (Mayhew):

1200^c VENEZUELA, Caracas, Radiotiempo ID 0300 9/17 poor o/WOAI QRM. Heard just for contest (

1265^c ST. KITTS, Radio Paradise in very strong 0155 9/17 w/"New Life" rel pgm, full ID 0159 then filler mx til 0200 & into another rel pgm. (Mayhew) § R. Paradise w/poor-fair signal on 10/6 u/considerable sloop from WXYZ-1270, WNDR-1260, WWYN-1260. Rel pgm at 2320, positive ID taped 2330, f/out by 2340. Heard sporadically later on in the eve. Country no. 8 heard here. Maybe catches like this will be easier if I can ever scrounge up enough funds to buy an SM-2 (Ball)

1270 CUBA, Camaguey, Reloj Nacional was local-strengthen w/no QRM de 1270 10/14 0613 & later on actually entire MM (Fader) Now squarely on 1270 khz, ex-1269 (RFS)

1365 HONDURAS, Danlí, R. Danlí noted 10/4 w/clear ID at 0306 (Stanbury)

1370[?] MEXICO, unID at 1235 10/19 using "Radio Ranchito" slogan. No R. Ranchito listed in MexiGlenn list or in IRCA Foreign Log. Anyone have any idea on what this one may be? I'm certain the freq was 1370, as I also heard a "KEEN" ID & there was much sloop from my local, KGB-1360. I've used both my IRCA loop & my Sanserino loop & found both picked up the stn equally well (Lobel) XEHG in Mexicali, BC, per NRC edition of MexiGlenn List (RFS)

1420 MEXICO, Tijuana, BC, XEXX fair & alone o/het w/WHK off 0734-40 10/21. Loud taped ID after each ranchera selection giving call ("X-E-doble X"), freq, 2 kw power & location (Francis)

1500^c MEXICO, D.F., R. Tricolor ID 0705 9/22, SS, C&W mx, weak w/poor WDEE. Reheard for contest (Mayhew) // (Foxworth):

1520 COLOMBIA, Barranquilla, R. Minuto atop the freq w/WKBW blanked out in aurora 0530 9/16.

1550[?] UnID, SS talk noted 0730-0800 10/14, unreadable. Who might this have been? (Fader) La Voz Portaña - Barranquilla? (RFS)

....[?] UnID alone on freq 0650-0700 10/7 w/romantic vocals, low-key SS anc, frequent "Radio Reloj" ID's (Francis) Sure got me! (RFS)

1560 CUBA, Cárdenas, Reloj Nacional 10/20 was in strong 0700 UTC when they ID'ed as Radio Reloj Nacional. They seemed to be reading the nx. SS OM & YL w/YL giving the time each minute (Shaw)

1570 MEXICO, Cd. Acuña, Coah., XERF in extremely well 0457 10/21. ID in EE 0500 then into FF lgg pgm (Huh? -RFS). I recorded the ID but instead of XERF it sounded as tho he said XERL (Shaw) We've been thru that before! (RFS)

1580 MEXICO, Hermosillo, Son, XEDM, Radio Pacifico in strong at 0615 10/21. At 0620 man ID'ed as "de-eme" (DM) & mentioned Hermosillo (Shaw)

International QSL Roundup

834 BELIZE, Radio Belize sent map card in 14 days for 2 IRC's. Wish they would send out veries in outer envelopes so they wouldn't get so hacked up in the mail (Ball)

Must close fast, as the airmail jet leaves in an hour. Thanks all again for a super DXWW1. Stay tuned for the CAT & the great DXWW2 § 73 de RFS

DJAKARTA, INDONESIA (NRB)-Four years ago it was estimated that there were more radio stations per square mile in Indonesia than any other country in the world. At that time there were nearly 350 stations in the capital city of Djakarta:

Since that time, strict government regulations have reduced the number of stations considerably. Stations are licensed locally, making it difficult to list all that are in operation, although estimates currently stand at 350 for the entire country.

Yaski Studio in Djakarta has taken advantage in this interest in radio. The studio has offered its expertise to persons interested in establishing radio stations or receiving help with stations already on the air. Consequently, Yaski Studio has developed a network of about 80 stations which air programs produced in Yaski Studio in Djakarta.

Yaski Studio is an Indonesian sister organization to FEBEC. It currently receives some financial support from the Far East Broadcasting Company, although increasing local support is making it more self-sufficient. The studio produces programs for use on international shortwave stations operated by FEBEC, as well as the network of stations in Indonesia. Programs include "Science Corner," Christian drama and preaching programs. The programs are distributed on high quality cassettes.

Yaski Studio has offered extensive consultation to cooperating stations regarding studio design, transmitter layout and other technical subjects. Two "how to do it" books on programming and technical problems have been produced jointly with a local Christian publishing foundation.

western dx forum
 Editor: Michael G. Worst,
 4618 Fremont N., #104
 Seattle, WA 98103

Bill Harang, 811 Nevada Ave., San Jose, CA 95125
 Latest DX catches include KTLK-1280 and CFAC-960. LBG: welcome back to the West Coast! I found it interesting to read Gary Parton's 10/5/74 DXF report. I'm glad to hear that he's back in the Bay Area. I wish him the best in his hopes of a career in broadcasting. A little kid (brat) poured some Coca-Cola into my little Zenith Royal 15 transistor radio. Funny, but true! The Coke sure didn't help it! Charley Keleher's comments at the end of his 9/7 CDXR was interesting. I'm surprised to find out that he had trouble hearing CBU-690 Vancouver clearly because of KNBR slop. One would probably think, if he didn't know otherwise that CBU would be stronger because of its much closer distance. It was also a surprise to find out that CBR-1010 Calgary came in good from the location of Seattle without many problems from KOMO-1000. San Diego IRCA members may be interested in knowing that Christopher Kane, formerly of KGB and KCBQ, is once again back at KYA-1260. 73s. (Bill's report was misrouted to Portland, Oregon. mw)

eastern dx forum
 Editor: Bruce R. Heimburger
 1710 Cambridge Rd.,
 Ann Arbor, MI 48104

Ray Arruda - 6 Wilbur Ave - N. Dartmouth, MA 02747
 Nothing but Mex., Cuban and LAs on the band in Oct. w/high levels of atmospheric noise & very poor overall ex which I find very unusual for this time of year. DXing has only been fair w/one new stn added to the log: WINY-1350. No sign of KKAA 1560, no veries and just a few rpts out. Fri. 10/18: CKJD Test not hrd due to QRM from WTAE, WDVA, & WKBR who was apparently AN w/rr. Sun. 10/20: WMOP Test tried but not hrd. TT first 1/2 hour but don't think it was them. MM 10/21: nothing but static and noise on the band w/nothing new hrd. KGHO Test tried but not hrd. O for 4 in DX Specials so far. Sure hope that future MMs aren't as bad as this one. 73

David R. Ball - 62 Lexfield Ave.
 Downsview, Ontario, Canada M3M 1M5

As a new member of IRCA, I thought I'd get started "on the right foot" w/a rpt to EDXF. First quick intro: I'm 16 years old, in Grade 12. I'm here in metro Toronto, in the NW end of the city. My receiver is a DX-150A & at present I use an E-W LW, which is really more of a short wire, not planning to purchase an SW-2 as soon as finances permit. Current MW totals are 145/114, 27/27, 5/5, 8/5. I'm also active on SW & a member of NASWA. Recent veries: v/l-WINE, WKBN, CNWW, WKCY, WJJD; v/q-WHBC, WOKY, R. Belize, CBEF, CFAC, KSL, KGLC, WOKO, KOA; v/c-WTOP; v/f-KFI, CJRS. One news item: The CRTC has proposed new regulations requiring Canadian stns to use 100% Canadian made ads by Oct. 1/75. Testifying at a public hearing, John Bassett, president of Eaton Broadcasting, owners of CKLW-800 in Windsor, said that such regulations would force CKLW to close down, since the majority of their ad revenue comes from the U.S. and U.S. advertisers would be unwilling to pay extra for Canadian-made ads. 73s

THE INTERNATIONAL RADIO CLUB OF AMERICA-- a non-profit club devoted to listening to distant radio stations on the broadcast band (540-1600 KHz). IRCA is a member of ANARC, the Association of North American Radio Clubs, dedicated to promoting cooperation between the radio clubs of North America.
 IRCA Officers: President: Richard C. Evans, Box 392, New Buffalo, MI 49117. (616-469-3866). Secretary-Treasurer: Carl Dabelstein, 3300 North 56th St., Lincoln, NE 68507; Board of Directors: Father Jack Pejza (Chairman), Bob Foxworth, Nancy Hardy, Percy Kesteven, Ed Krejny, Bill Nittler, John Zondlo. Membership dues in IRCA: \$2.00 per year.
 IRCA publishes the IRCA Foreign Logs, listing over 1500 foreign stations heard on the broadcast band from North America. Volume I, \$2.25; Volume II, \$3.00. Combination offer, \$5.00. Volume 3 available shortly.
 IRCA has an extensive list of reprints of articles and features which have appeared in DX Monitor in past years. Send a self-addressed stamped envelope for a copy of the list.
 IRCA stationery: 70 sheets for \$2.00; 100 sheets for \$2.75. Rubber stamp of club emblem, \$3.00. Permission is granted to publish, broadcast, or reproduce any of the material in DX Monitor (except items which acknowledge that they appear by permission from other sources, or material which is copyrighted), provided credit is given to DX Monitor and the author or contributor, if listed.
 DX Monitor is printed by Vanard Lithographers, San Diego, CA.

660
 "Voice of the Vandal"
 STUDENT SOUND
 KUOI
 UNIVERSITY OF IDAHO MOSCOW, IDAHO 83843

RADIO IS ALIVE AND WELL AND LIVING ON CFWH 570 CBC RADIO WHITEHORSE YUKON

POSTAL SERVICE
 NOV 2 1974
 PM

IRCA
 International Radio Club of America
 12536 Arabian Way, Poway, CA 92064



Dave Williams 17A
 Box 615, Hwy. 101
 Astoria, OR 97103

